

坚朗 KIN LONG®

Construction Hardware Expert
建筑五金专家

Point-fixed Glass Wall Fittings
Typical Product Catalogue



COMPANY PROFILE

UNIQUE VALUE CAN ONLY BE CREATED BY
PROFESSIONALISM, SPECULATION HAS NO FUTURE



Kin Long Company has been an innovative and professional company engaged in research, development, manufacture, and marketing of fittings for architectural hardware. Kin Long supplies fittings of high quality and provides consulting services to the architectural industry. Through many years' development, Kin Long achieves a good reputation in construction industry.

Kin Long has a factory of 200,000sq.m. with a construction area of 200,000sq.m. The total number of employees exceeds 5000, including over 500 technical and managerial personnel. With a developing sales network both home and abroad, its products are distributed through China and exported to more than 100 countries and areas.

Unique value can only be created by professionalism, speculation has no future. This motto is practiced by Kin Long personnel at all levels. In the continuous quest for constant technology development, higher quality and better services, today Kin Long has become the prominent and largest supplier of fittings for architectural hardware industry.

Striving to become the leader to serve the architectural hardware industry in the world, Kin Long not only adopts advanced management and manufacturing method, but also invests heavily in design and innovation. Till now, Kin Long has more than 10,000 items of products and owns more than 300 patents. The company has achieved acclaim in innovative design, elegant appearance, high quality products and unsurpassed services. Kin Long takes pride in supplying fittings to many famous landmarks in countless cities all over the world.

Kin Long is always your best and most reliable partner in supplying fittings for architectural hardware.



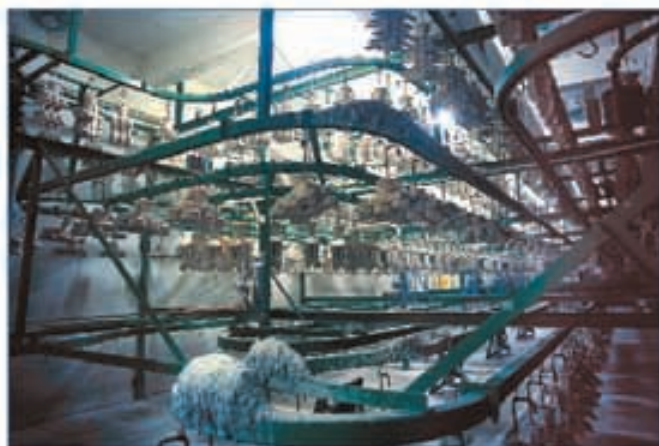



HONOUR QUALIFICATIONS

UNIQUE VALUE CAN ONLY BE CREATED BY
PROFESSIONALISM, SPECULATION HAS NO FUTURE



让世界见证 坚朗 KIN LONG LET THE WORLD WITNESS

December

Kin Long was awarded the Vice President of China Construction Metal Structure

March

Our company was awarded the honour as designated enterprise for PVC door and window

2008

November

Kin Long was honored with qualification of "National High & New Technology Enterprise"

June

Kin Long was honored as the Top 100 of the Manufacturing Enterprises in Guangdong Province of 2009

January

The Experimental Center of KINLONG has passed the National Certification Successfully

2009

December

Kin Long was awarded "Guangdong Province Famous Brand Product"

April

Kin Long Company was approved as "Patents-Cultivated Enterprise" in Dongguan city of 2009

January

Kin Long was honored as The First Headquarter Enterprise in Dongguan City.

2010



In 2009 and 2011

Kin Long was honored "Dongguan City Top 50 Private Enterprise"

Kin Long is identified as the Patent Cultivate Enterprise by Dong Guan Municipal Intellectual Property Bureau. Until now, Kin Long's patents have more than 300 items.

In October 2011

Kin Long's building window and door hardware won the Certification of Urban and Rural Construction Products, and it is awarded by Chinese Building Standard Design and Research Institute

In 2010 and 2012

Kin Long was honored as one of Top 500 Enterprises in Guangdong Province

Kin Long was specified with the door and window hardware sentinel enterprises by Committee of Building Doors and Windows Accessories of Chinese Construction Metal Structure Association in 2010 and 2012.

Kin Long got honor of the Taxing Over 100 Million of Tang Xia Town in 2012.

In December 2012

Kin Long was named the 2009-2012 Science and Technology Innovation Excellent Enterprise by Chinese Construction Metal Structure Association.

At the same time, Kin long was named with SACTC448 Advanced Standardization Committee.

In March 2013

Kin Long's voice side door system was identified as High Technology Product of Guang Dong.

In October

Kin Long won the First Prize of Science and Technology by Chinese Metal Structure Committee

In November 2013

Kin Long was named with the Voice President Enterprise of Chinese Construction Decoration Committee

In 2013, Kin Long ranked the seventh in the top 50 private enterprises of Dong Guan

2011

2012

2013

KINLONG

THE GATEWAY ARCH
POWER XANADU BIG BOOM



SOCIAL RESPONSIBILITY

UNIQUE VALUE CAN ONLY BE CREATED BY
PROFESSIONALISM, SPECULATION HAS NO FUTURE



Flying dreams

Helping Huaxia take off

We respect the responsibility back to society

Since 2005, there are 20 Hope Primary Schools devoted by KINLONG in impoverished mountainous areas of Gansu, Hunan, Yunnan, Anhui, Chongqing, Sichuan and Guizhou.

In order to satisfy students' thirst of knowledge, Kin Long also sets Kin Long Bursary Fund in 8 universities located in Zhejiang, Shanghai, Harbin, Chongqing.

To the best of our ability, Influence everyone around, help Huaxia take off

20 KINLONG Hope Primary Schools:

- Jiangnan Kinlong Hope Primary School in Anhui County, Hunan
- Qiaochou Kinlong Hope Primary School in Eryuan County, Yunnan
- Zhugang Kinlong Hope Primary School in Changfeng County, Anhui
- Dongan Kinlong Hope Primary School in Chengkou County, Chongqing
- Maierma Kinlong Hope Primary School in Aba County, Sichuan
- Huajiang Kinlong Hope Primary School in Guangling County, Guizhou
- Beao Tibetan Kinlong Hope Primary School in Yuexi County, Sichuan
- Guanghan Cottage Kinlong Hope Primary School in Xiangdong District, Pingxiang, Jiangxi
- Wanshan Kinlong Hope Primary School in Tongren, Guizhou
- Honbridge Kinlong Hope Primary School in Wei Ji Town, Shangshui County, Henan
- Yongkang Shentan Kinlong Hope Primary School in Shapotou District, Zhongwei, Ningxia

Content

1、Product Material Introduction	01
2、The Surface Finish Effect of the Product	02
3、MS structure point-fixed glass curtain wall system	03
4、Economical products	04-11
5、Routel	
Routel	12-13
Flat Cap Routel	14-19
Countersunk Routel	20-25
The Reference Drawings for the Glass Hole Punching and the Alu.Sleeve ---	26-27
Splice Routel	28-29
6、Connector	30-34
7、Spider	
Standard Spider	35
Spider for the end of Tension Rod	36-59
Fin Spider	60-76
8、Kinds of Wrenches	77

Note: The main products of point-fixed department include the products shown in the catalogue and other non-standard products related to these types of standard products. These non-standard products include the change of the section view, dimensions, sizes, etc. Please refer to curtain wall fitting catalogue for clamp, tension cable, tension rod, cast-in channel and so on.



Product Material Introduction

1、Cast stainless steel material:

- The standard material:CF8M、CF8 (American Standard Austenitic Stainless Steel for casting ,its integrative performance is better than that of 316、304 cast stainless steel).
- Commonly used material:CD3MN (American Standard Duplex Stainless Steel,its strength is double of the CF8M、CF8 Stainless Steel.Its decay resistance performance is better than that of CF8M、CF8).
- Nonstandard material:Other materials which requested by clients(Mainly referring to materials which are similar to the CF8M、CF8、CD3MN)

Note:We supply the CF8M、CF8 cast stainless steel if clients do not mention the specific casting materials in the contract.If any other material is requested,please give us the clear indication in the contract.

2、Non-cast stainless steel material:

- The standard material:316、304 (American Standard Austenitic Stainless Steel)
- Commonly used material:2205(American Standard Duplex Stainless Steel,its yielding strength is double of the 316、304 stainless steel.Its decay resistance performance is better than that of 316、304.)
- Non standard material:Other materials which requested by clients(Mainly referring to materials which are similar to the 316、304、2205)

Note:We supply the 316、304 non cast stainless steel if clients do not mention the specific material in the contract(Except some small accessories).If any other material is requested,please give us the clear indication in the contract.

3、Instruction:

The non rust of the stainless steel means it can have certain chemical stability around the corrosion mediums of air、water、acid、alkali、salt or others.But it does not mean the stainless steel will never rust. Whether the stainless steel will rust or not is influenced by the molecular structures,the processing technic,the operating environment and so on.To prevent the stainless steel from rusting extremely,please pay attention to the following factors:

- The die and casting parts should be carried out the solution treatment according to requirements.
- Choosing the reasonable stainless steel mark according to the operating environment.
- Selecting the reasonable surface treatment
- Taking protection measures of hardware products into action on site.
- The design and application of the hardware should avoid soot formation and seeper.
- Cleaning the hardware regularly to avoid long time being smudged.

The surface finish of the stainless steel accessories for the point-fixed glass curtain wall



This page shows the standard surface finish effect of our company. If any special requirement of the surface finish being requested, please send the model for our analysis and approval.

MS structure point-fixed glass curtain wall system

System Components

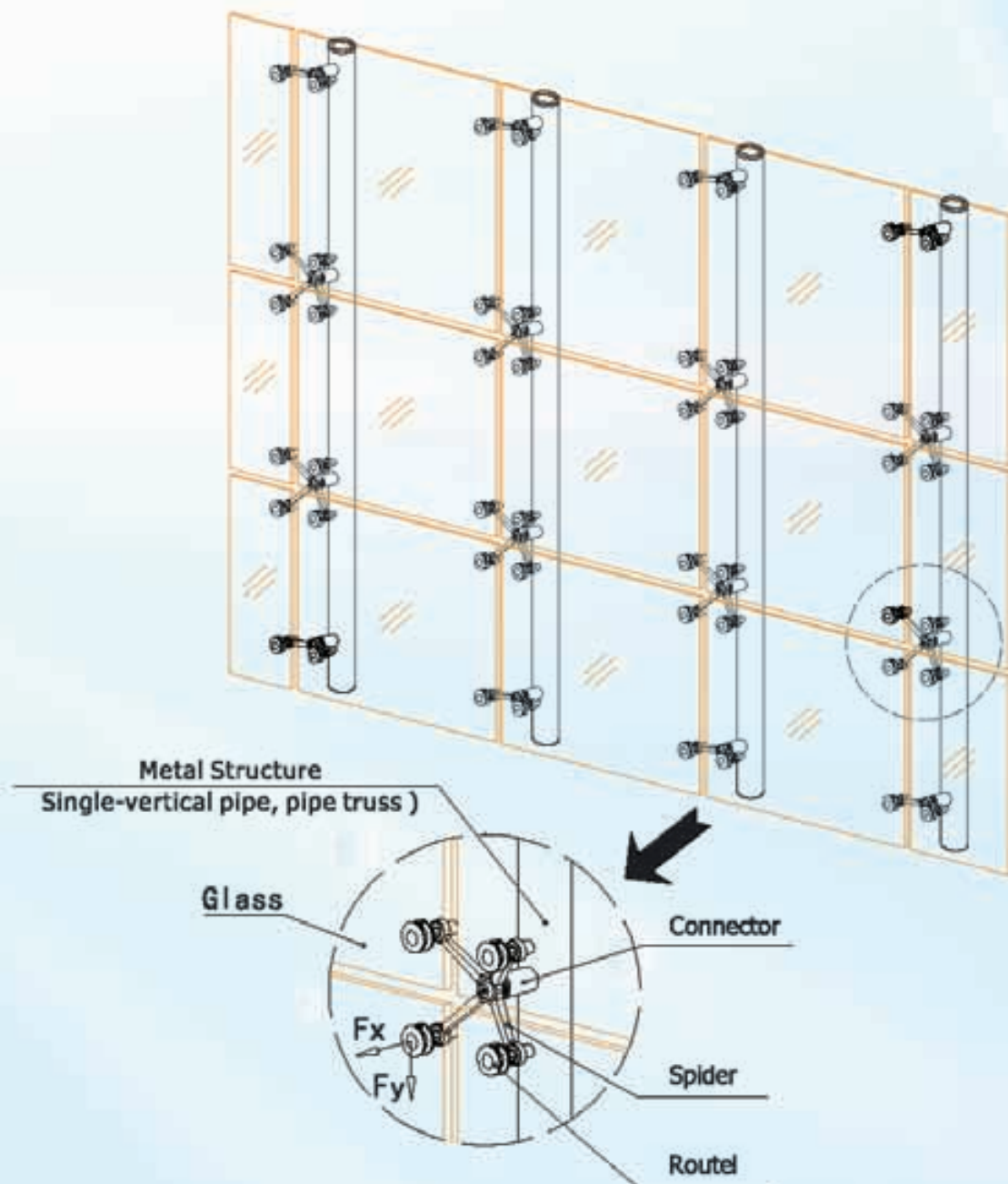

F_x and F_y represent axial and radial forces which the glass passes to point-fixed accessories.

Economical products

Economical products, which are named in comparison with KinLong standard products, are designed and developed for the projects requiring a lower bearing capacity. The main characteristics are including the smaller bearing parameter and lower prices than that of KinLong standard products. In order to distinguish the economical products and standard products, we add "A" before the type to indicate the Routel's recommended value of bearing capacity.

●Technical parameters

No.	Model	The design value of axial bearing capacity(N)(Negative air pressure)	The design value of radial bearing capacity(N)(The glass weight)	可偏转角度不小于
1	ATF11、ATF12	3000	1500	± 5°
2	ATF13	3500	2000	
3	ATF14	4000	2500	
4	ATC11、ATC12	3000	1500	
5	ATC13	3500	2000	
6	ATC14	4000	2500	

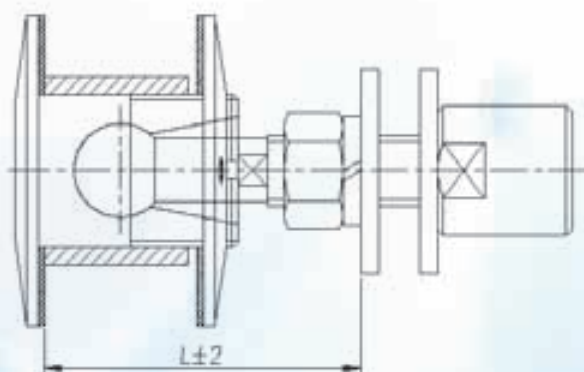

When the actual length "L" is longer than the "L" in this catalogue or the actual loading capacity is larger than the recommended value in the table, the products may not meet your needs and for detailed information, please consult our technical department.

●Technical parameters

No.	Model	The design value of axial bearing capacity(N)(Negative air pressure)	The design value of radial bearing capacity(N)(The glass weight)
1	A200Aseries	2000	800
2	A220Aseries	2000	1000
3	A250Aseries	2500	1200
4	A300A(B300A)series	2500	1500
5	A3060Hseries	4000	1800

Flat Cap Routel

ATF11

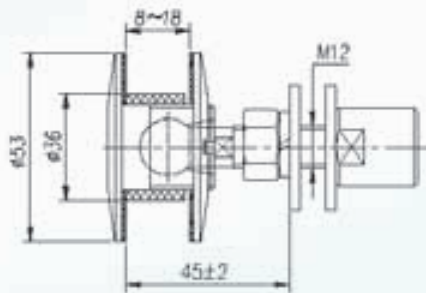

ATF12

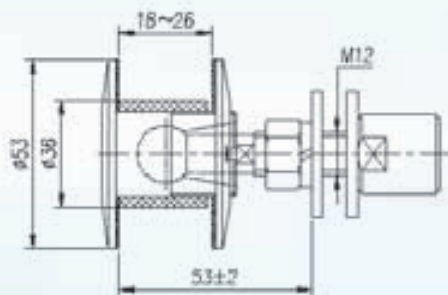

ATF13

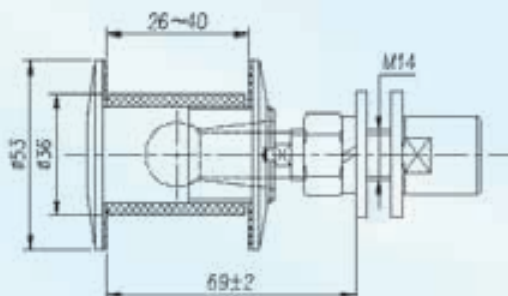

ATF14

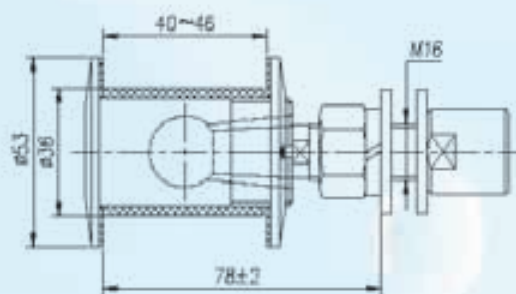

Countersunk Routel



ATC11

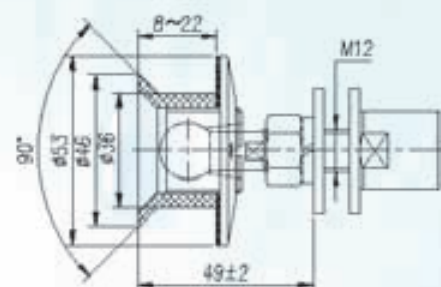

ATC12

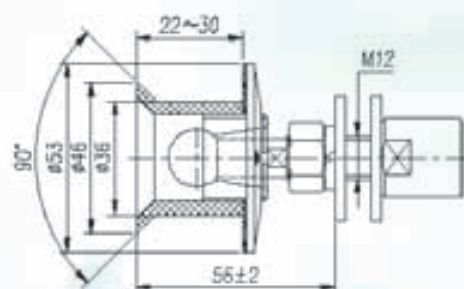

ATC13

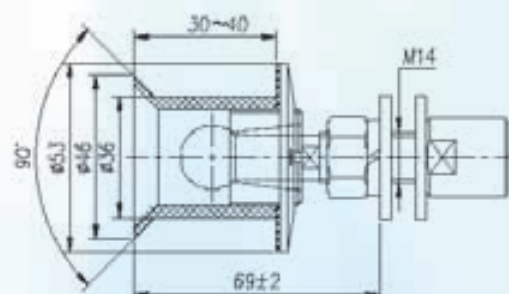

ATC14

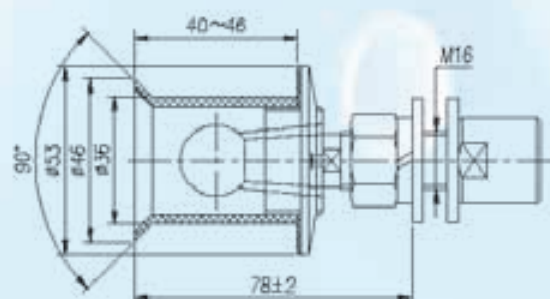

A200A Series

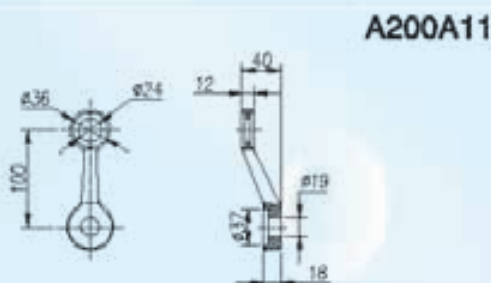
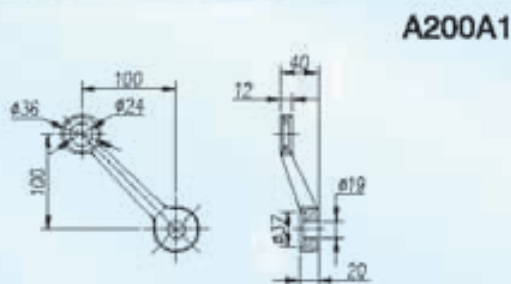
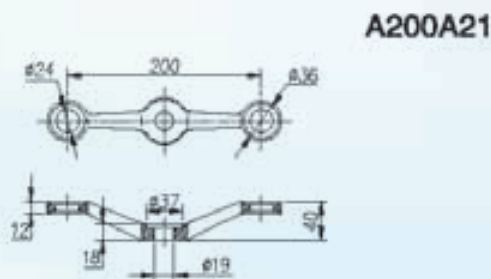
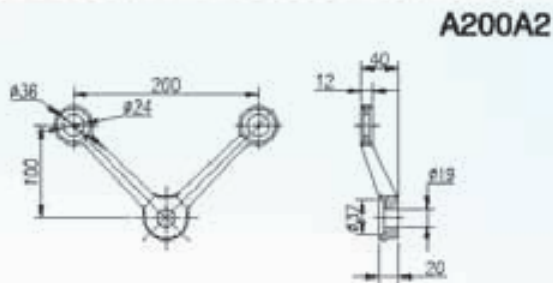
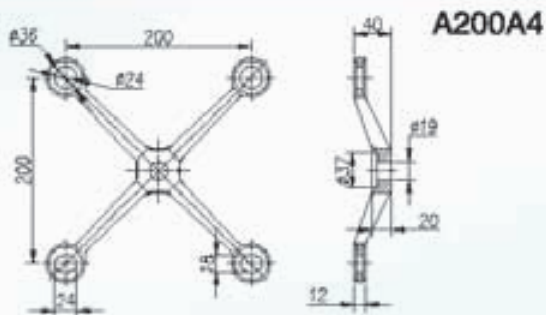

A220A Series



A220A4

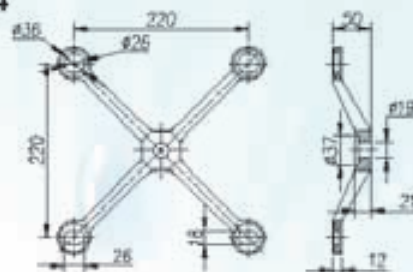

A220A2

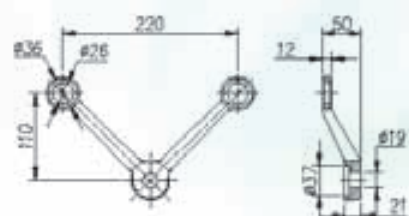

A220A21

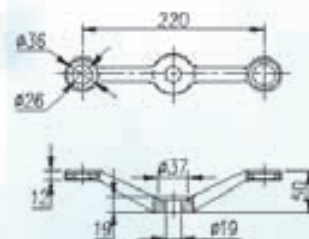

A220A1

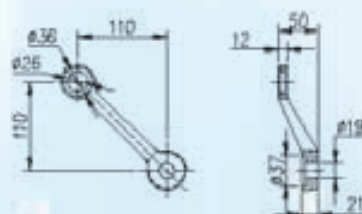

A220A11

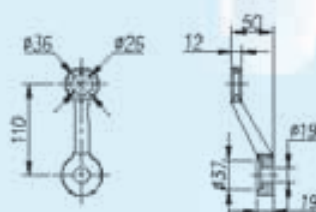

A250A Series

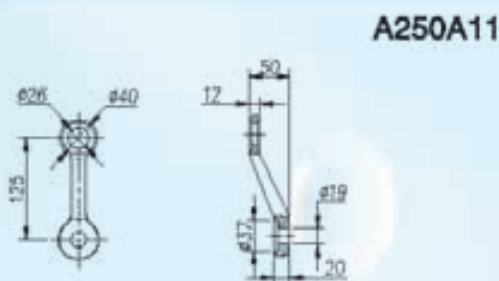
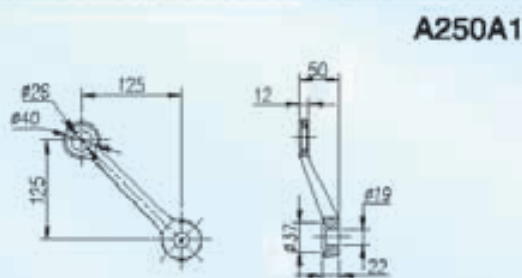
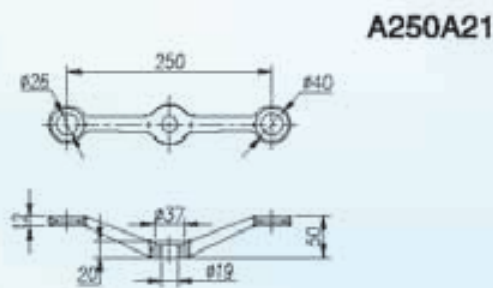
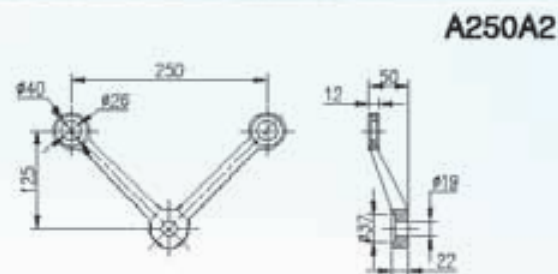
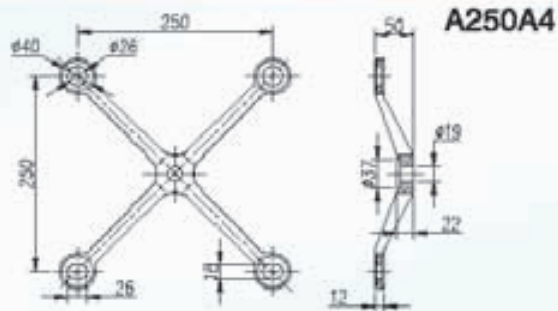

A300A(B300A) Series



A300A4(B300A4)

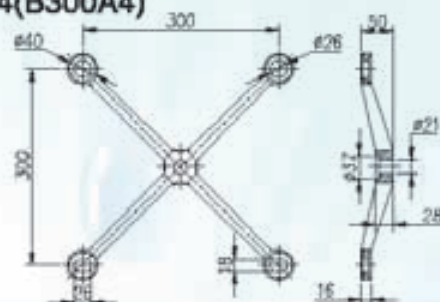

A300A2(B300A2)

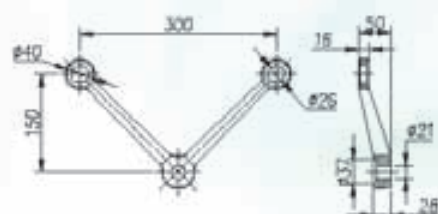

A300A21(B300A21)

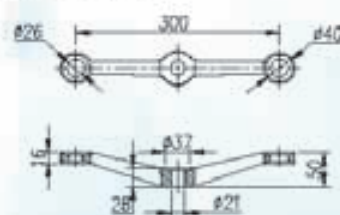

A300A1(B300A1)

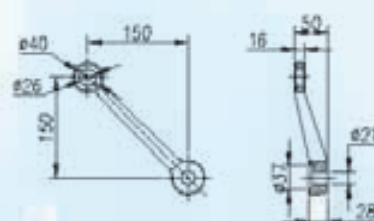

A300A11(B300A11)

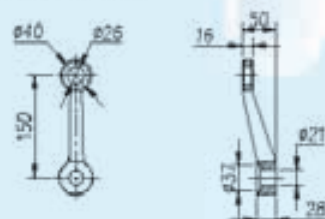

A3060H Series

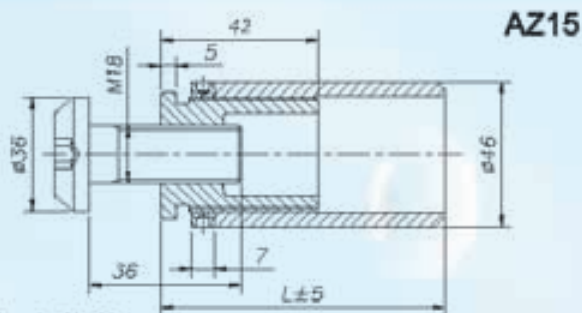
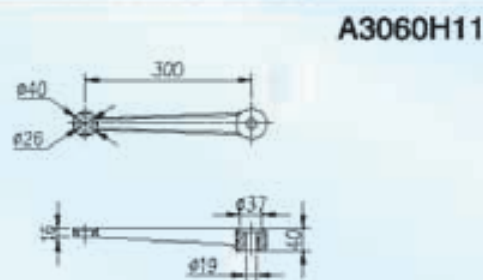
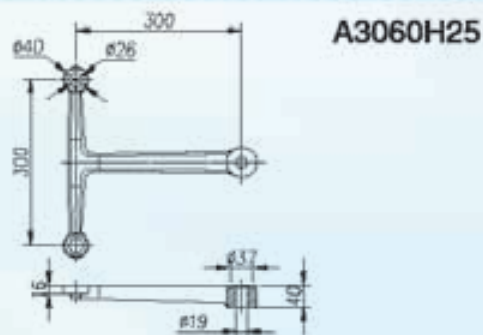
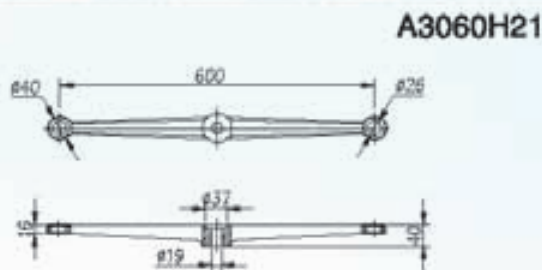
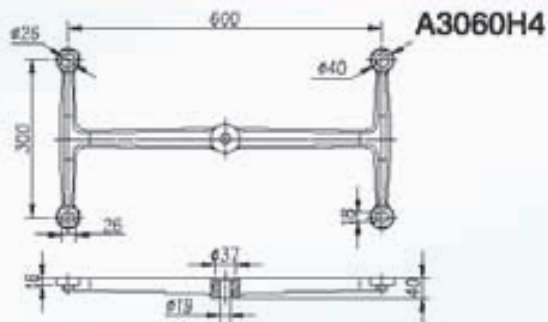

Regular point-fixed glass wall fittings

Routel

• Principle for making the model number

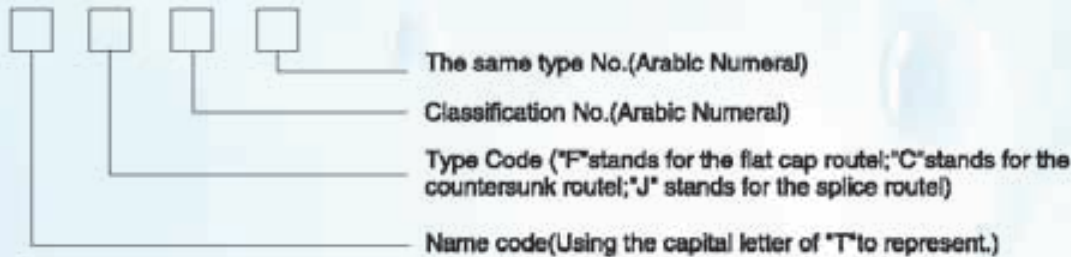

• The commonly used computing formula of the accessories' selection

① The weight of the glass panel

$$G_x = T \cdot B \cdot H \cdot \rho$$

G_x — The weight of the glass panel (N)

T — The valid thickness of the glass (mm)

B — The width of the glass (m)

H — The height of the glass (m)

ρ — The gravity density of the glass (Default: 25.8)

② Radial Force

$$F_y = 1.2 G_x / n$$

F_y — The radial force for a single hole (N)

G_x — The weight of the glass panel (N)

n — The number of loading, usually supposed to be 2. It represents that the glass weight is supported by the upper two holes.

③ Axial Force

$$F_x = q \cdot B \cdot H / n$$

F_x — Axial bearing capacity (N)

q — Even distributed design value of the load on the glass panel, mainly supposed to be the wind load (N/m²)

B — The width of the glass (m)

H — The height of the glass (m)

n — It is usually four, represents four-point supporting. This formula cannot be adopted to the supporting of more than four points.

• Main Technical points

- ① The spherical hinged routel: It can reduce the stress concentration of the glass holes caused by the glass deformation.
- ② Heat insulation routel: Adopting the Bridge cutoff theory to the design. It can reduce the heat loss of the interior and the surface sweating of routel.
- ③ Outside installation routel: It mainly used to the condition when there is not enough room for installation or it is not convenient to install from inside, but easy to install from the outside.
- ④ The dust-proof routel: The dust-proof cover can prevent the dust from entering the rotating part of the routel to avoid affecting its normal function.
- ⑤ The routel applies to the hollow glass (laminated glass): the advantage of this routel:
 - a. Avoiding the possibility of water seepage of the routel.
 - b. The surface of the glass curtain wall will be more beautiful.
- ⑥ The routel with the adjustable off center: To adjust the off center magnitude of the routel through turning the aluminium washer and the base.



• The recommended value for the loading of the routel(s.s.316、304)

No.	The routel code	The recommended value of axial bearing capacity(N) (Negative wind load)	The recommended value of radial bearing capacity(N) (Dead weight)	To deflected angle is not less than °
1	TF11A、TF12A	4500	2000	± 10°
2	TF13A、TF23A	6000	2500	
3	TF14A、TF24A	6500	2800	
4	TF21A、TF22A	6000	2500	
5	TF11、TF12、TF31、TF32	4500	2000	± 5°
6	TF21、TF22	6000	2500	
7	TF13、TF23、TF33、TF35	6000	2500	
8	TF14、TF24、TF34、TF36	6500	2800	
9	TF41	2500	1200	
10	TF42	2500	1200	
11	TF43	4500	2000	
12	TF44	4500	2000	
13	TF51	4500	2000	
14	TF52	4500	2000	
15	TF54	4500	2000	
16	TF55	6000	2500	
17	TF56	6000	2500	
18	TF57	6000	2500	
19	TC11A、TC12A	4500	2000	± 10°
20	TC13A	6000	2500	
21	TC14A	6500	2800	
22	TC21A、TC22A、TC23A	6000	2500	
23	TC24A	6500	2800	
24	TC11、TC12	4500	2000	± 5°
25	TC13	6000	2500	
26	TC14	6500	2800	
27	TC21、TC22、TC23	6000	2500	
28	TC24	6500	2800	
29	TC31、TC32	4500	2000	
30	TC33、TC35	6000	2500	
31	TC34、TC36	6500	2800	
32	TC41、TC42、TC44	2500	1200	
33	TC43	4500	2000	
34	TC51、TC52	4500	2000	
35	TJ11、TJ12、TJ13	6000	2500	
36	TJ15、TJ16、TJ25	6000	2000	
37	TJ21、TJ23	6000	2500	

Flat Cap Routel



TF11
TF11A

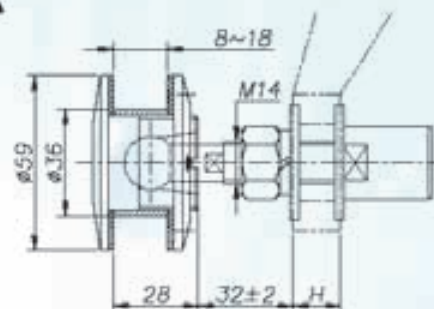

TF12
TF12A

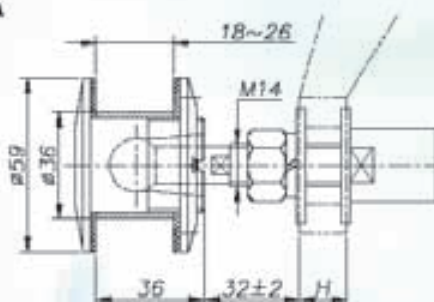

TF13
TF13A

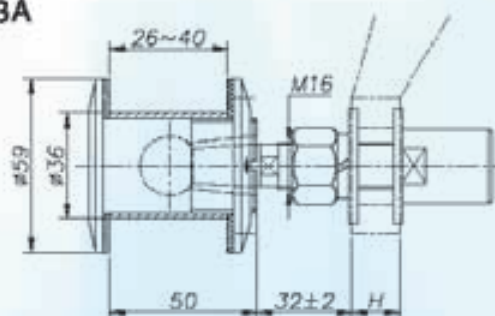

TF14
TF14A

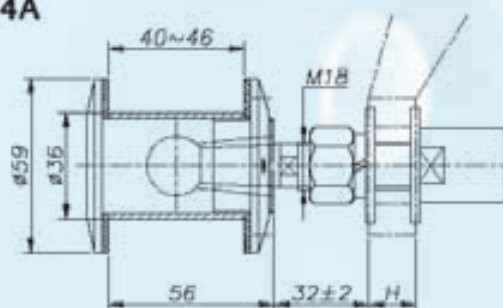

Flat Cap Routel

TF21
TF21A

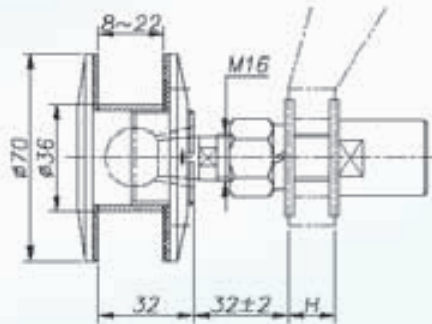

TF22
TF22A

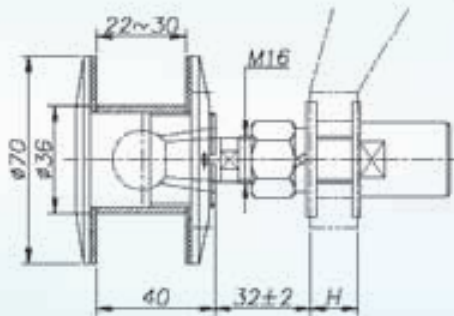

TF23
TF23A

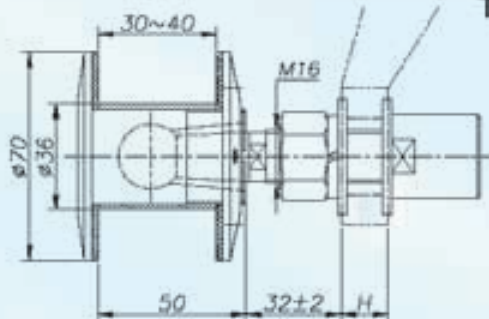

TF24
TF24A

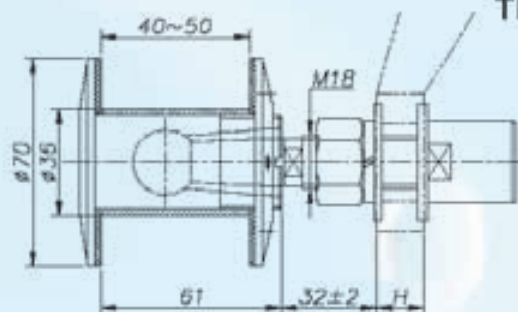

Flat Cap Routel



TF31

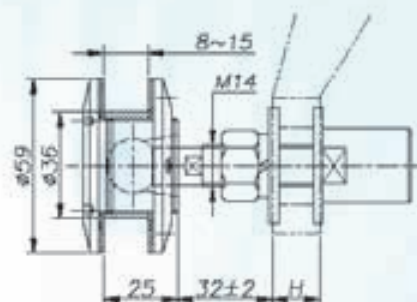

TF32

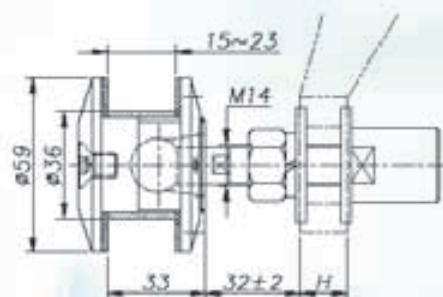

TF33

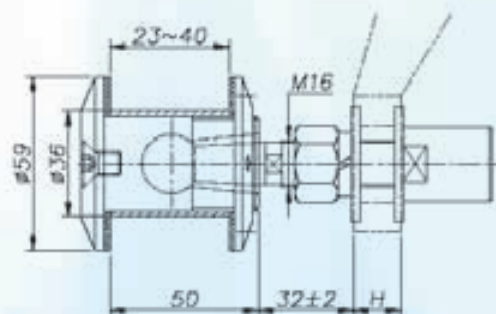

TF34

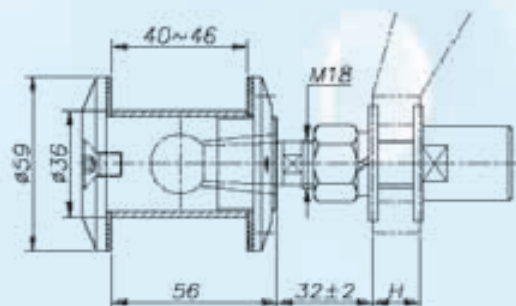

Flat Cap Routel

TF35

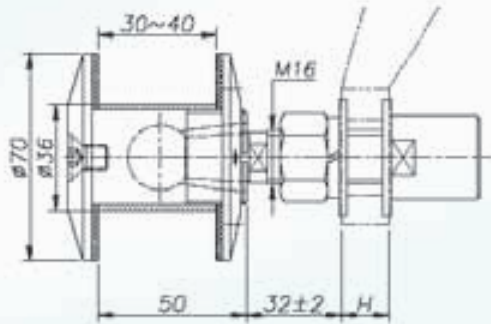

TF36

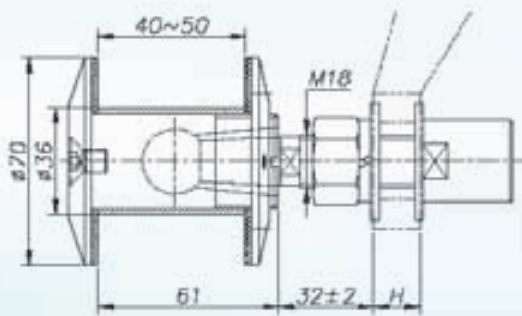

TF41

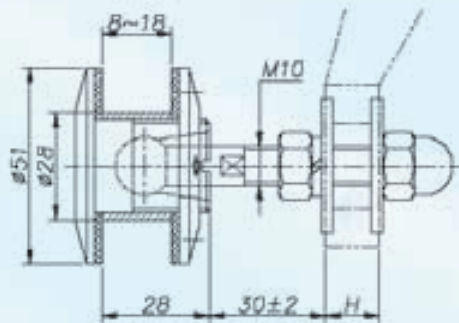

TF42

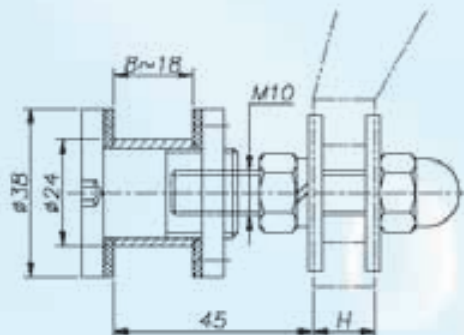

Flat Cap Routel



TF43

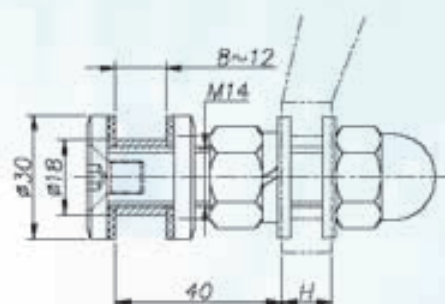

TF44

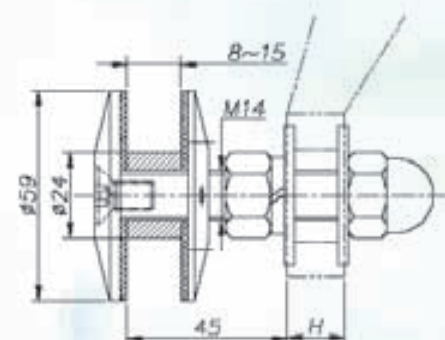

TF51

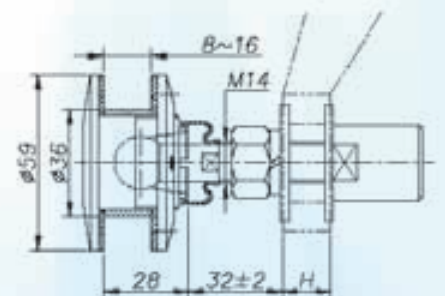

Dust-Proof Routel



TF52

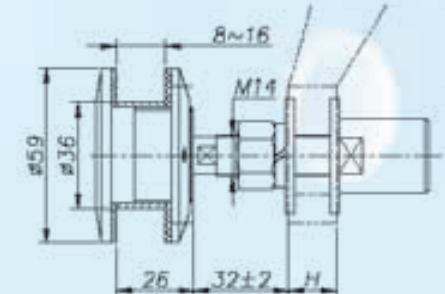

Flat Cap Routel

TF54

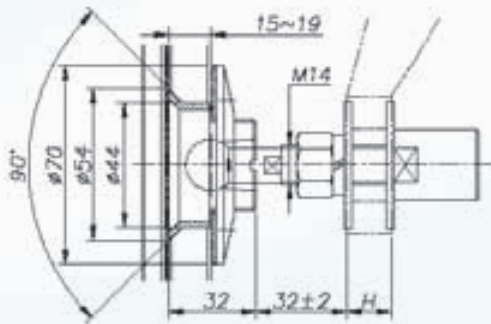

Routel for laminated glass

TF55

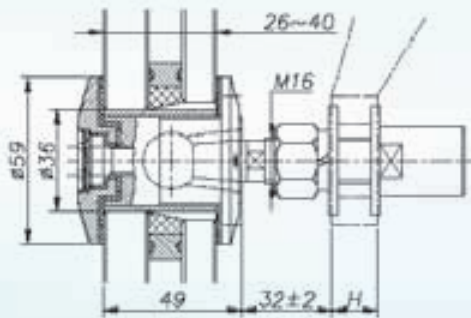

Routel with thermal insulation function

TF56

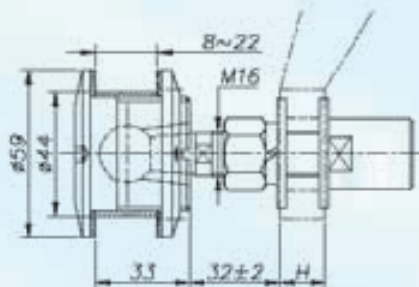

TF57

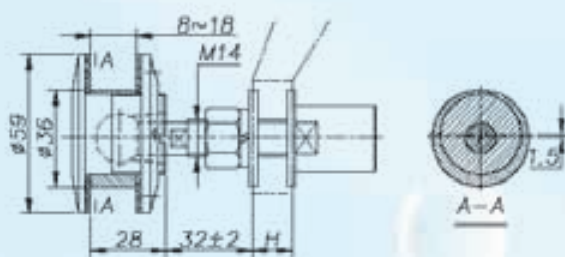

Routel with adjustable offcenter

Countersunk Routel



TC11
TC11A

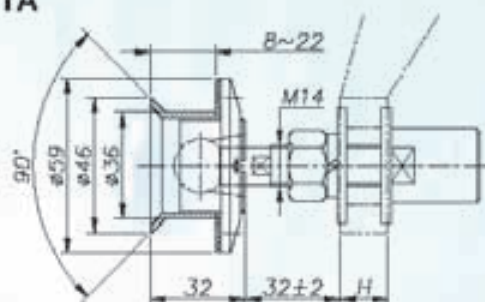

TC12
TC12A

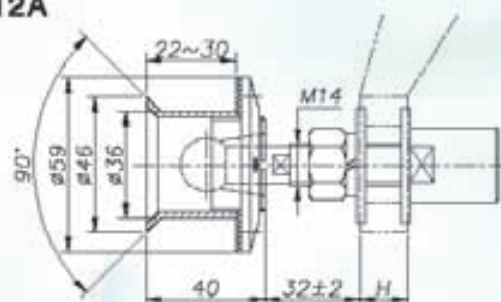

TC13
TC13A

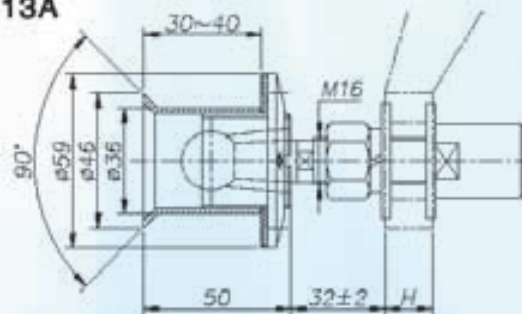

TC14
TC14A

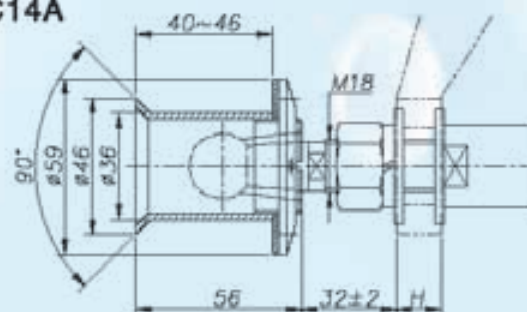

Countersunk Routel

TC21
TC21A

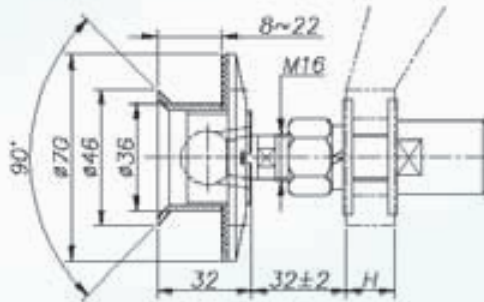

TC22
TC22A

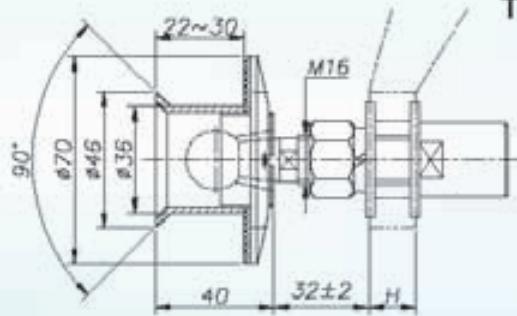

TC23
TC23A

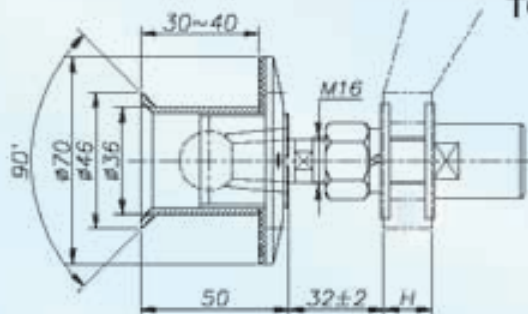

TC24
TC24A

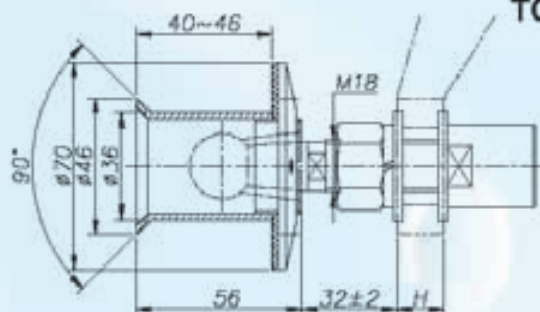

Countersunk Routel



TC31

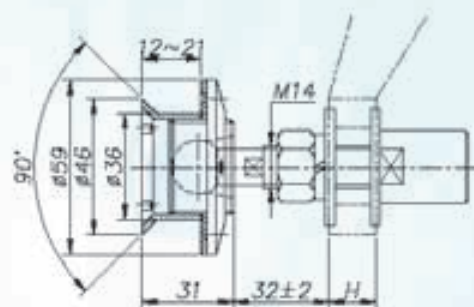

TC32

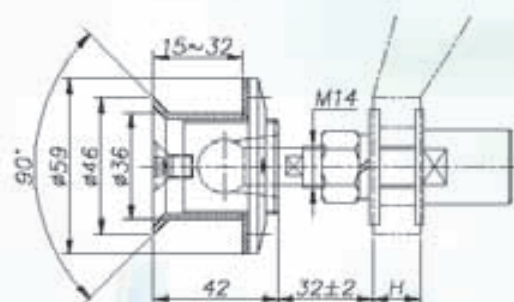

TC33

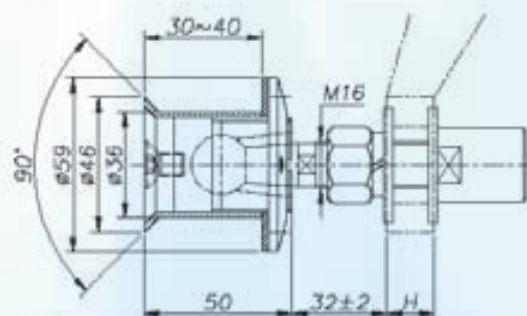

TC34

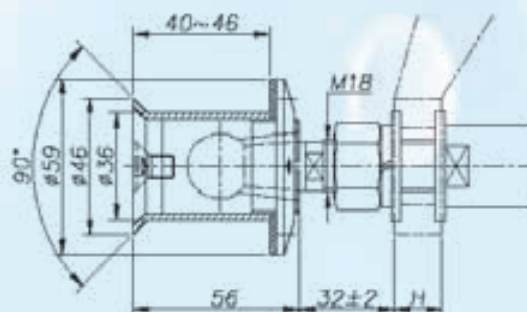

Countersunk Routel

TC35

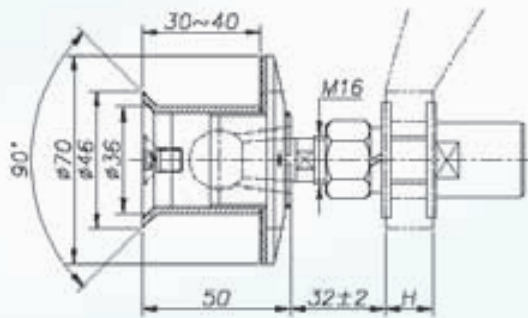

TC36

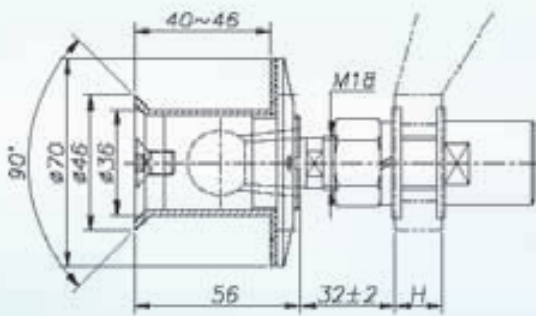

TC41

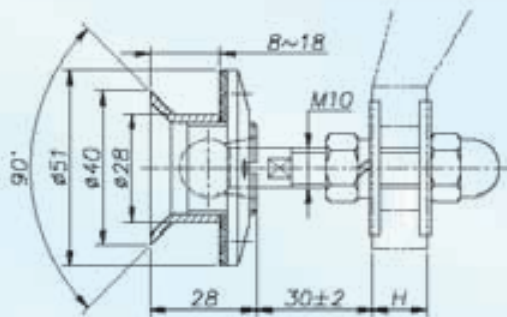

TC42

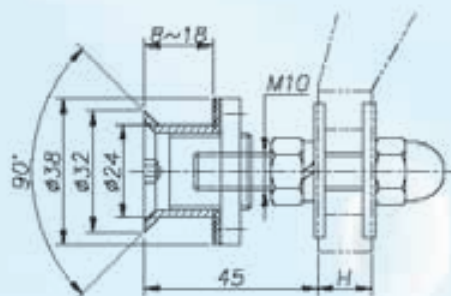

Countersunk Routel



TC43

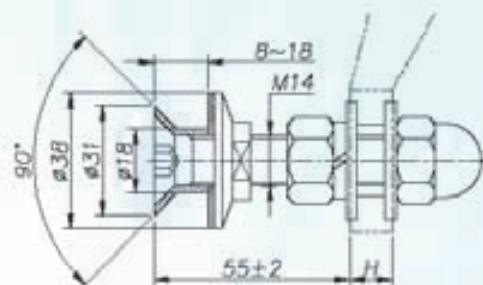

TC44

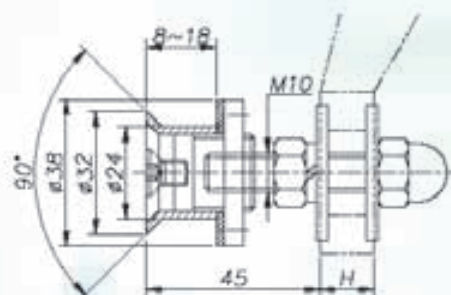

Dust-Proof Routel

TC51

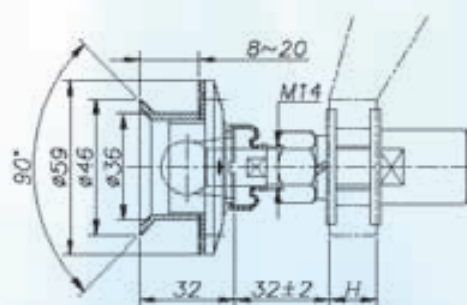

TC52

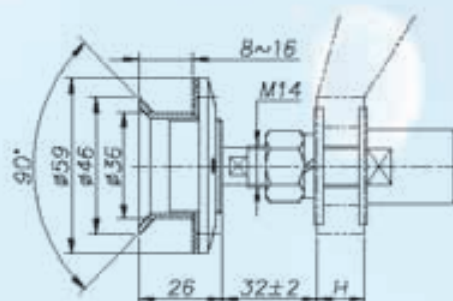



Reference Drawing for the hole drilling

Suitable for:
TF13、TF14、TF23、TF24
TF33~TF36、TF55

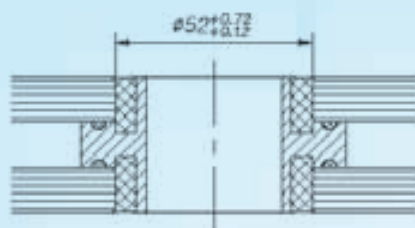

Suitable for:
TF13、TF14、TF23、TF24
TF33~TF36、TF55

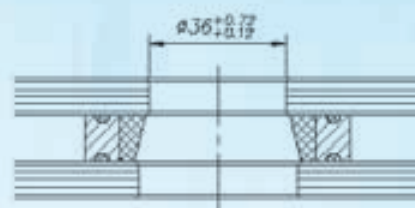

Suitable for:
TF11~TF13、TF21~TF23、TF31~TF35
TF51~TF52、TF55、TF57

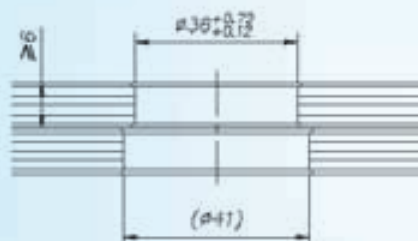

Suitable for: TF43



Suitable for:
TF11、TF12、TF21、TF22、TF31
TF32、TF51~TF52、TF57

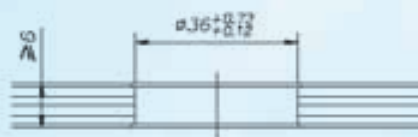

Suitable for: TF42



Suitable for: TF56

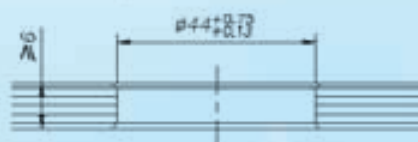

Suitable for: TF41





Suitable for:
TC11~TC13, TC21~TC23
TC31~TC33, TC35, TC51

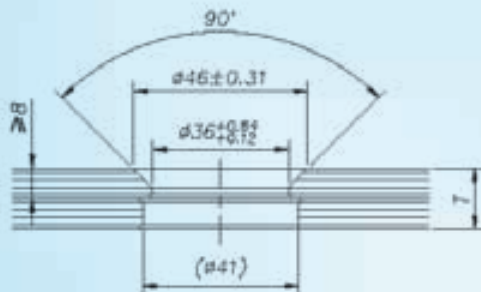

Suitable for:
TC11, TC21, TC31, TC32
TC51, TC52

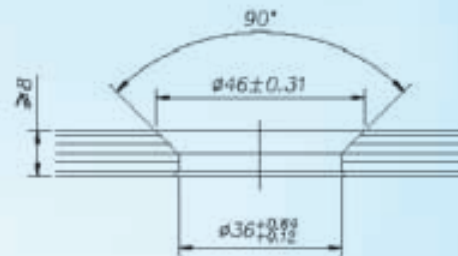

Suitable for: TC43

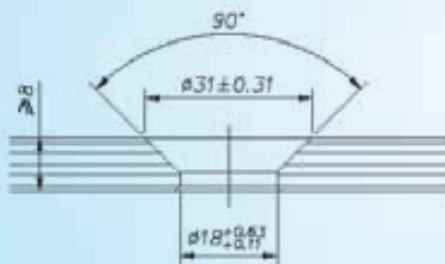

Suitable for:
TC13, TC14, TC22~TC24
TC32~TC36

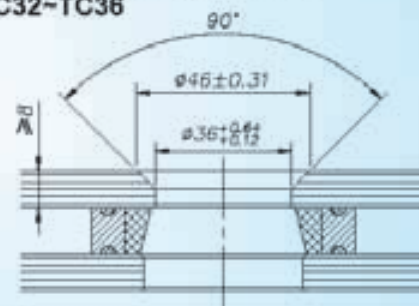

Suitable for: TC41

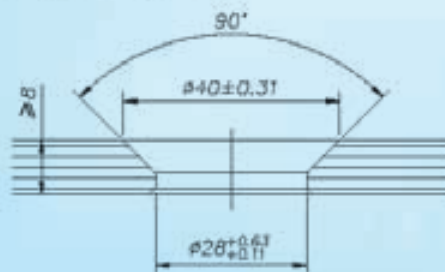

Suitable for: TC42, TC44

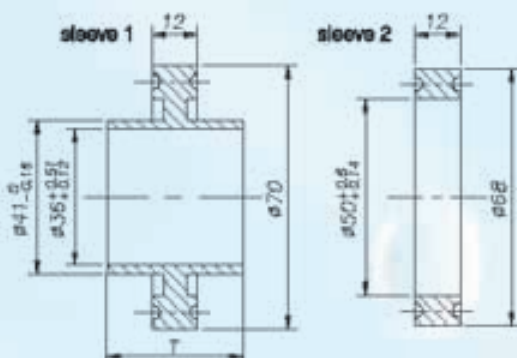
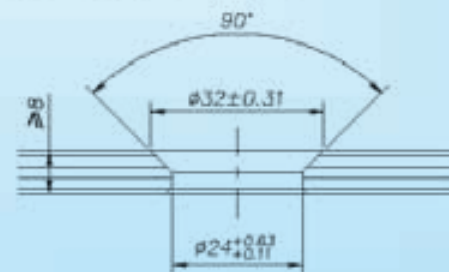

Alu sleeve for IGU



Splice routel



TJ11

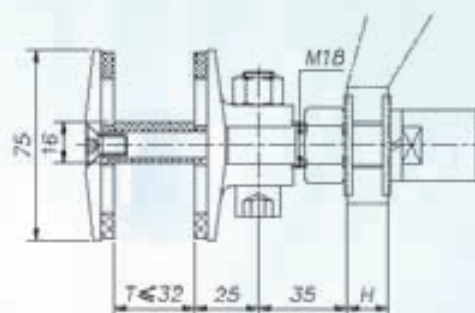

Routel with thermal insulation function

TJ12

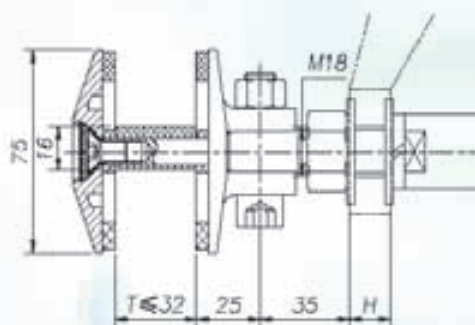

TJ13

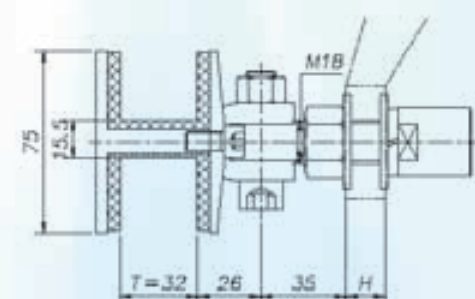

TJ15

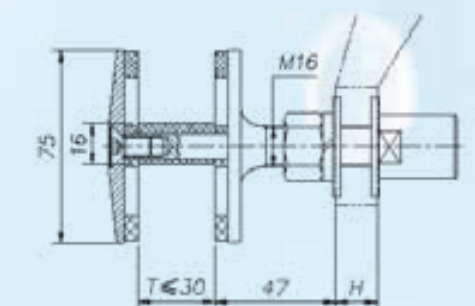

Splice routel

TJ16

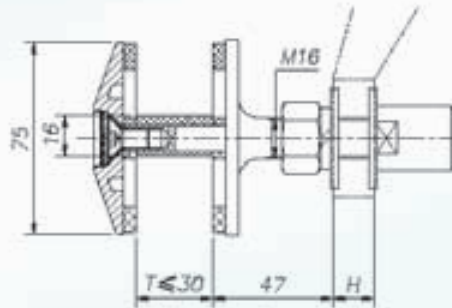

Routel with thermal insulation function

TJ21

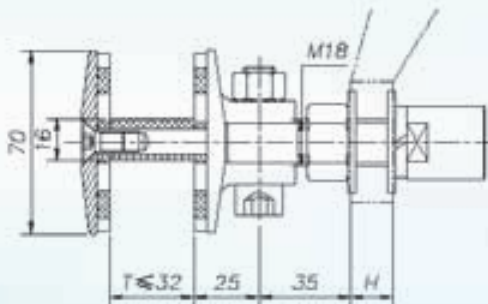

TJ23

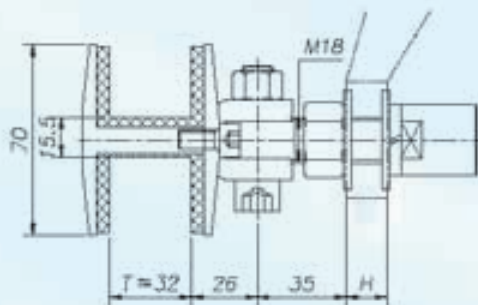

TJ25

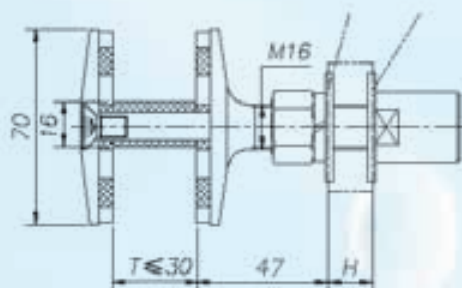

Connector

● Principle for making the model number

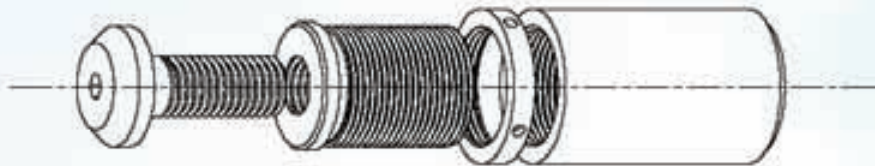
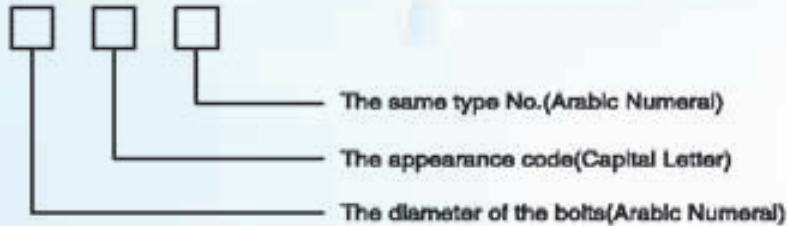

Exploded view

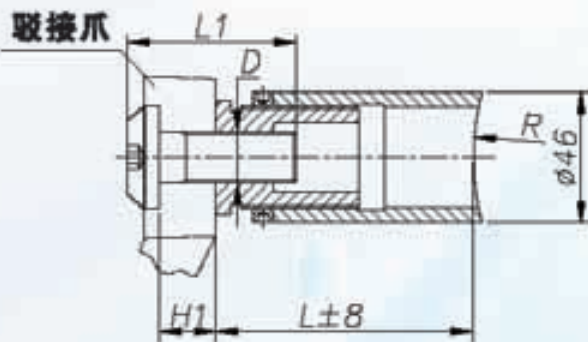

Non-standard type 1

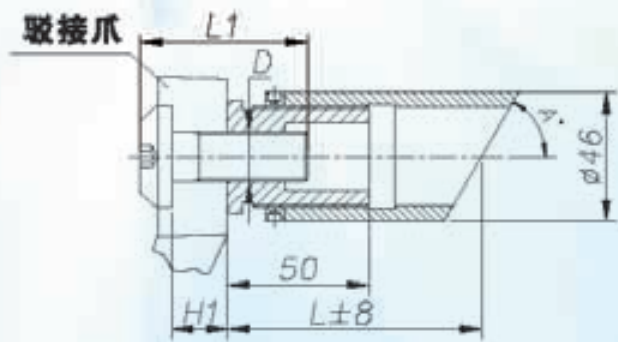

Non-standard type 2

Note:

The above two patterns are frequently-used non-standard type. Please provide the corresponding parameter of "L1", "R", "A" in the drawing in order to ensure that the final manufactured dimension is in line with your requirements.

The material of the base for connectors is usually the Carbon Steel Q235. When the stainless steel material for the base is needed, please add "B" to the end of the connector code.

The standard length $L1$ of the connector is noted in the drawing.

$D=M18$, When choosing the length, the dimension $L1$ series include 47, 70, 80, 90, 100mm.

$D=M20$, When choosing the length, the dimension $L1$ series include 60, 70, 90, 100mm.

Please select the size in above, We need assessment if you choose the dimension out of this range.

Connector

Z12

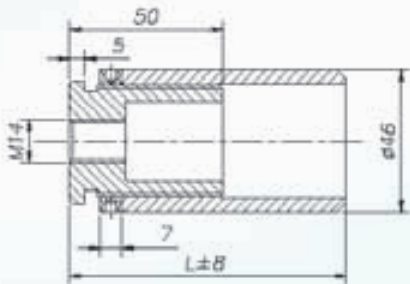

Note: Standard L=90



Z13

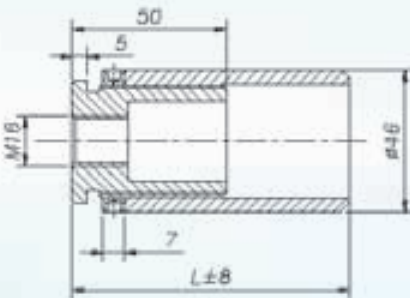

Note: Standard L=90



Z15

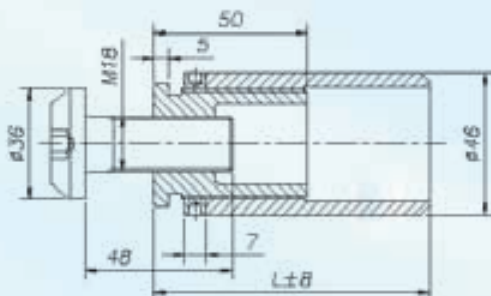

Note: Standard L=90



Z15L1

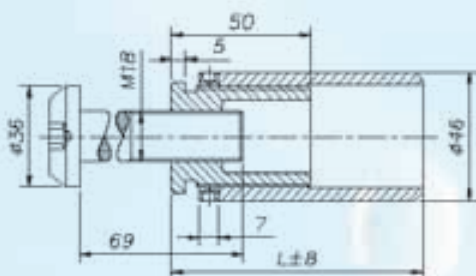

Note: Standard L=90



Connector



Z16

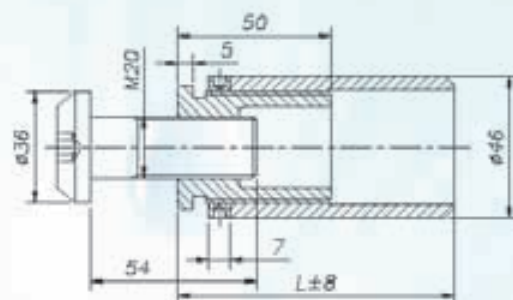

Note: Standard L=90



Z16L

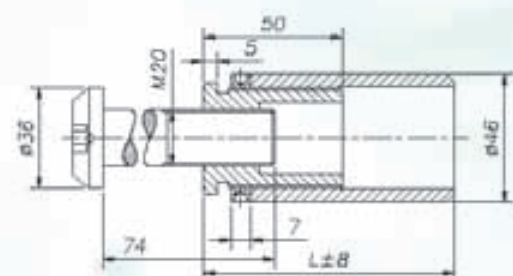

Note: Standard L=90



Z17

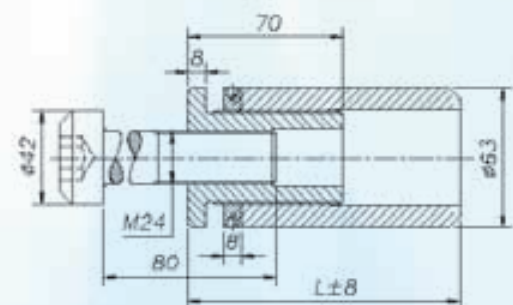

Note: Standard L=120



Z17L

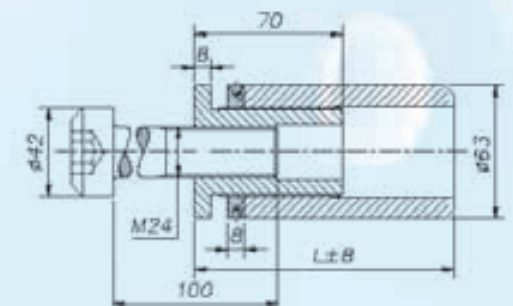

Note: Standard L=120

Connector

Z25

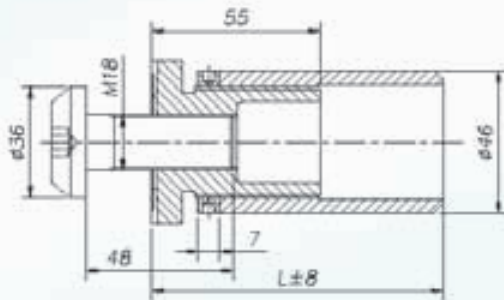

Note: Standard L=95



Z26

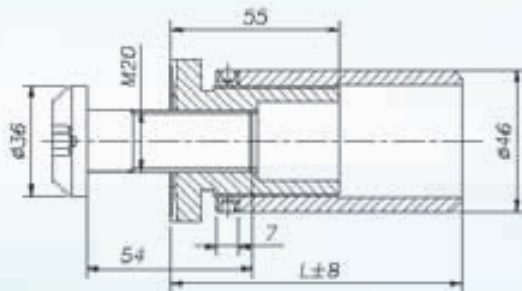

Note: Standard L=95



Z35

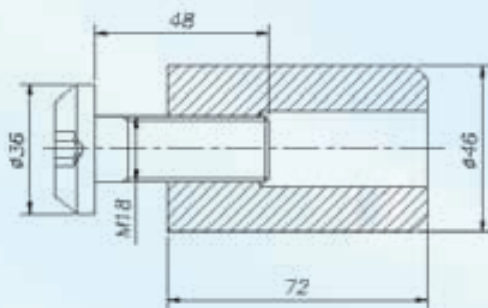

Z36

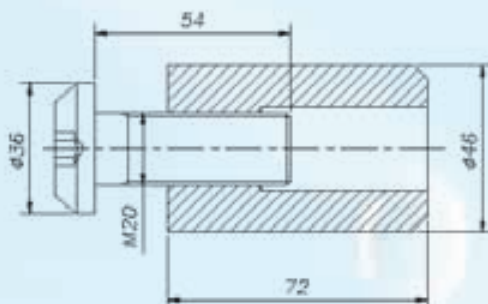

Connector



Z38

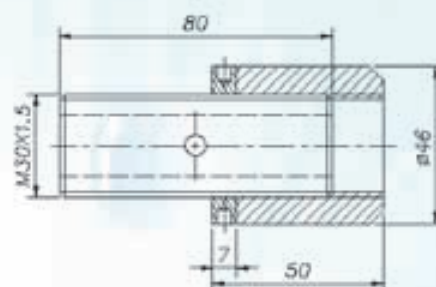

Z51

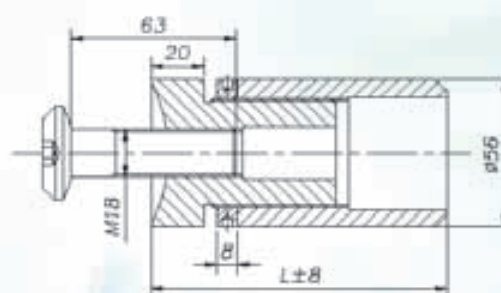

Note: Standard L=113



Z65

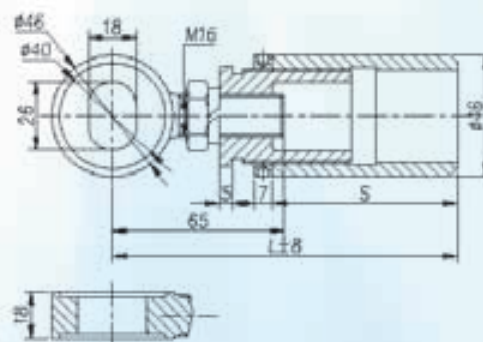

Note: Standard L=130



Z66

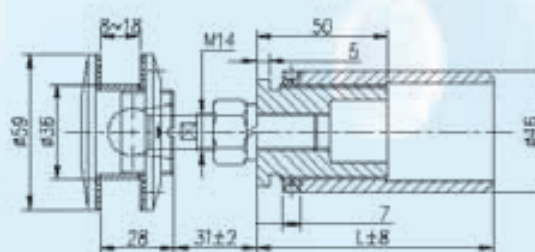

Note: Standard L=90



Spider

• The principle for making the model number

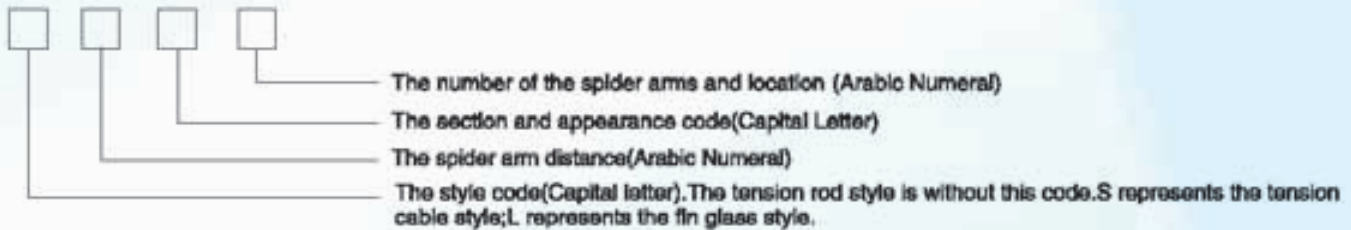

• The recommended value for the loading of single arm of spider.

No.	Spider Series Code	Material: CF8M、CF8		Material: CD3MN	
		The recommended value of axial bearing capacity(K) (Negative wind load)	The recommended value of radial bearing capacity(K) (Dead weight)	The recommended value of axial bearing capacity(K) (Negative wind load)	The recommended value of radial bearing capacity(K) (Dead weight)
1	200 Series*X* Shape	2000	1000	2600	1300
2	220 Series*X* Shape	2000	1200	2600	1600
3	250 Series*X* Shape	2500	1500	3300	2000
4	300 Series*X* Shape	3000	2000	3900	2600
5	250 Series*H* Shape	2500	1500	3300	2000
6	300 Series*H* Shape	3000	2000	3900	2600
7	3060A Series	3500	1500	4500	2000
8	2540HA Series	6500	2000	8000	2600
9	3060HA Series	6500	2500	8000	3200
10	4080HA Series	6500	3500	8000	4500
11	2542T、3040B Series	4000	2000	5000	2600
12	3060TA Series	3000	2000	3900	2600
13	J3030T Series	5000	2000	6500	2600
14	4706 Series	4000	2000	5000	2600
15	5006K	3800	2000	5000	2600
16	A5006K	1500	1000	2000	1300
17	L210 Series	2000	1000	2600	1300
18	L220 Series	2500	1500	3300	2000
19	L240 Series	3500	1000	4500	1300
20	L250 Series	2500	1500	3300	2000
21	L300A、L300E、L300F	3000	---	3900	---
22	L300B、L300C、L300D、L300G	3000	1500	3900	2000

Note: We reduced the products code and style to make the order and installation easier.The spiders in this products catalog had been made the following alterations:

The dimension of the flat holes of the four-arm spiders is designed according to the M18 screw.When the installed screw to the elliptical holes is less than M18,the axial load of the router will transfer from the offset washer to the spider.It can be seen from the test,when the axial load is less than 3500N,the offset washer can totally meet the requirements of the stress.In addition,the original design of the elliptical holes of the single arm,two-arm,three-arm spider has been cancelled.The needed bearing of the holes should also be transferred from the offset washer.

If three-arm spider is needed, customers should add the number of arms in the end of the code such as:the code of three-arm 250A Spider is 250A3.

200A Series



200A4

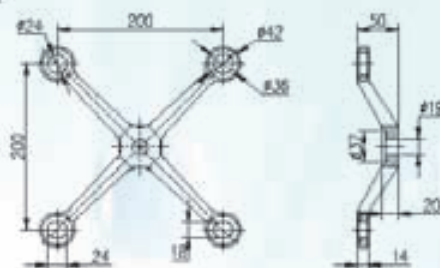

200A2

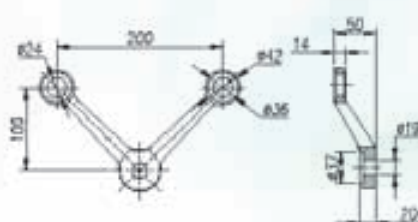

200A21

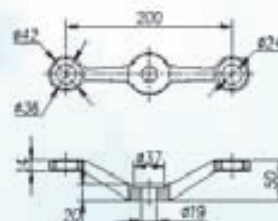

200A1

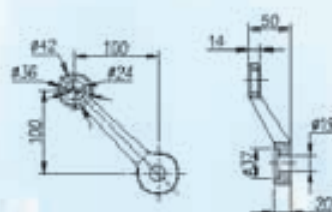

200A11

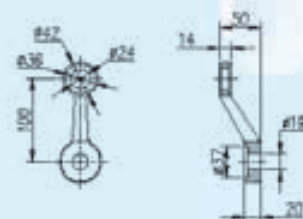

200B Series

200B4

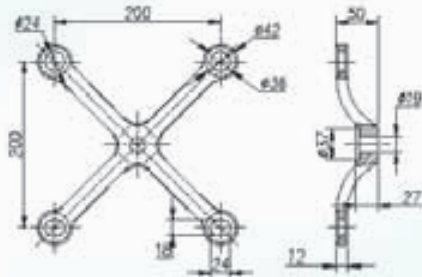

200B2

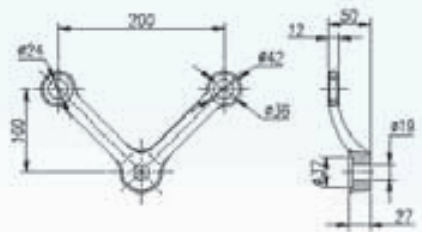

200B21

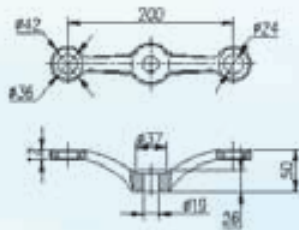

200B1

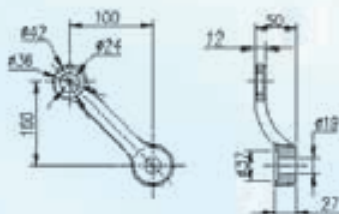

200B11

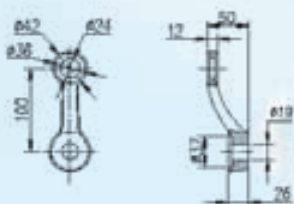

200C Series



200C4

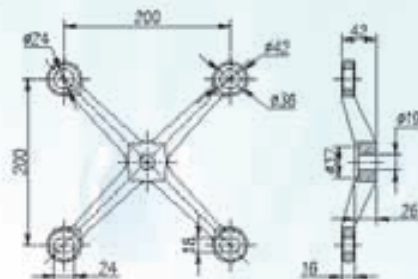

200C2

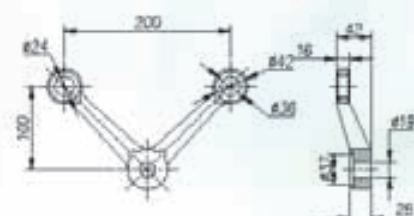

200C21

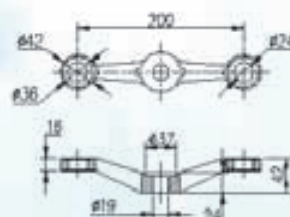

200C1

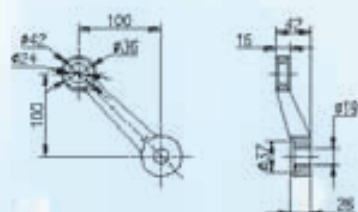

200C11

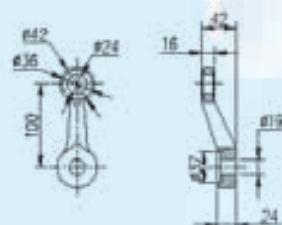

220A Series

220A4

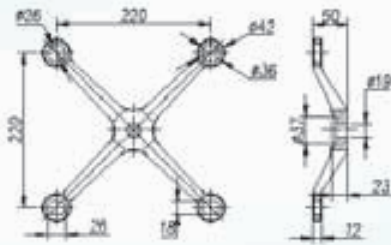

220A2

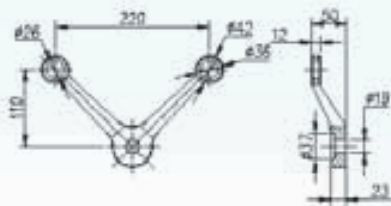

220A21

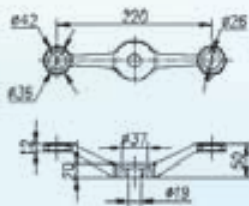

220A1

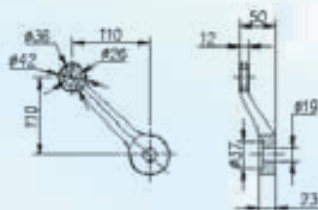

220A11

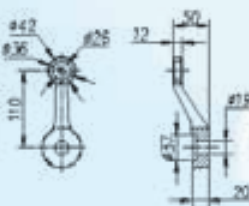

220B Series



220B4

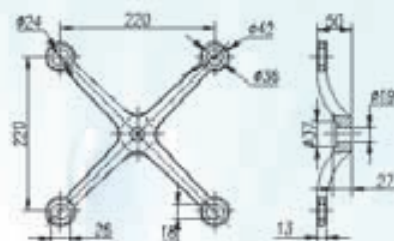

220B2

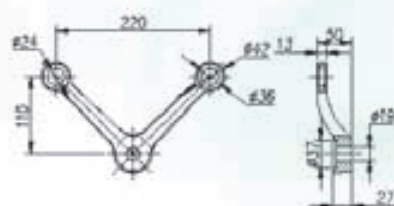

220B21

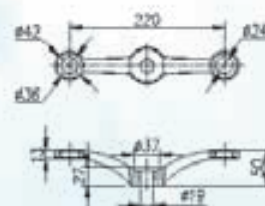

220B1

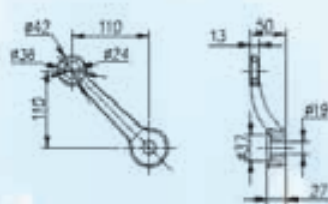

220B11

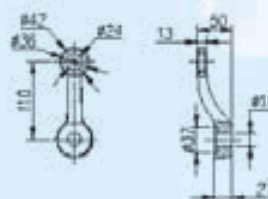

250A Series

250A4

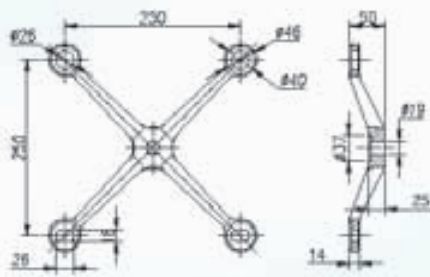

250A2

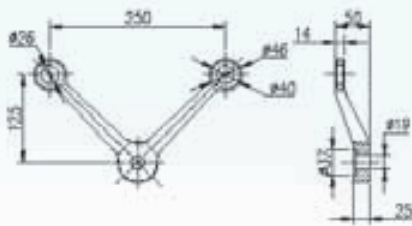

250A21

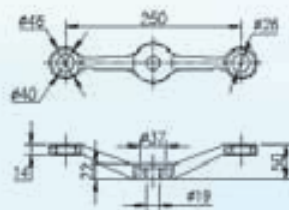

250A1

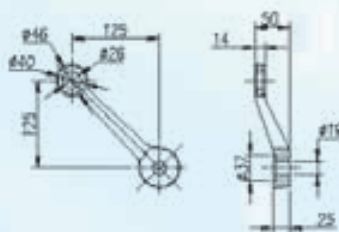

250A11

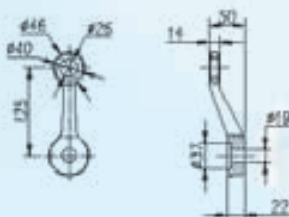

250B Series



250B4

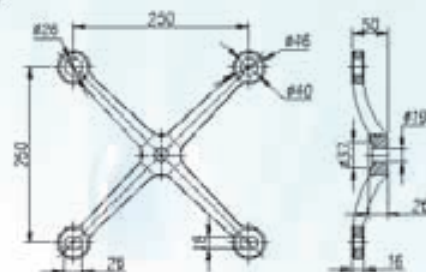

250B2

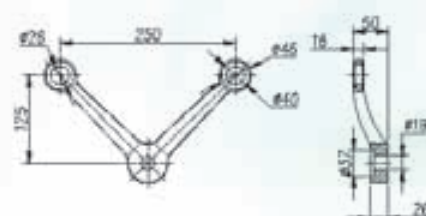

250B21

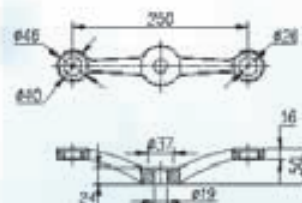

250B1

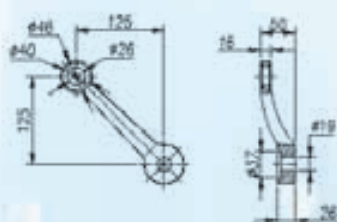

250B11

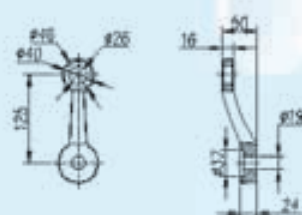

250C Series

250C4

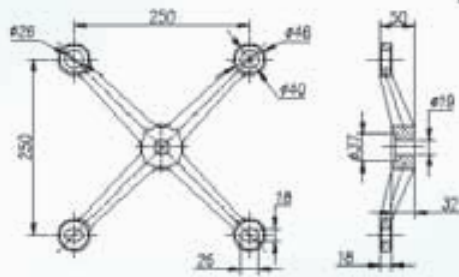

250C2

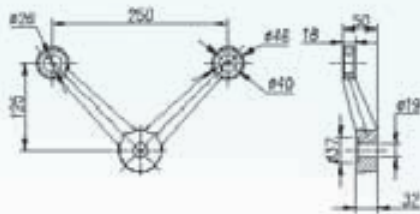

250C21

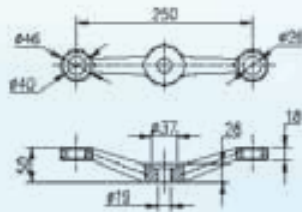

250C1

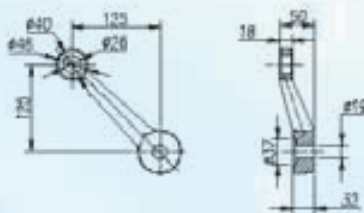

250C11

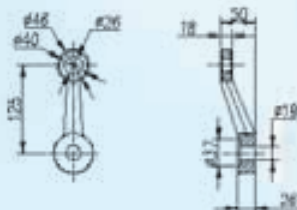

250K Series



250K4

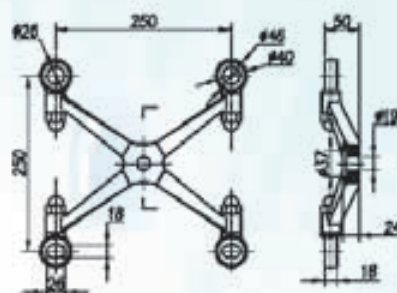

250K2

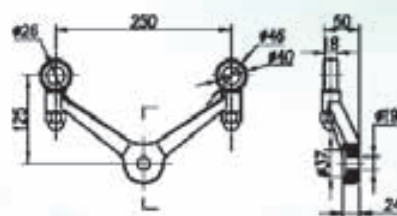

250K1

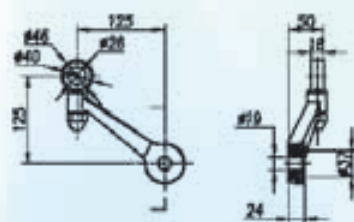

250K12

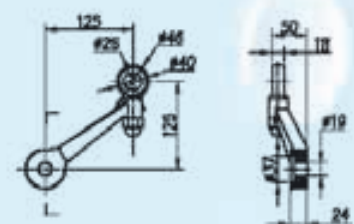



300A Series

300A4

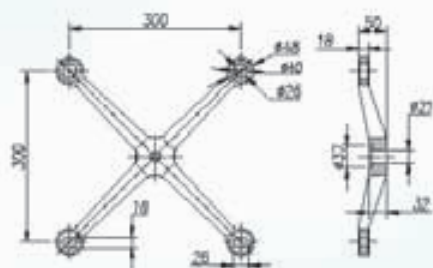

300A2

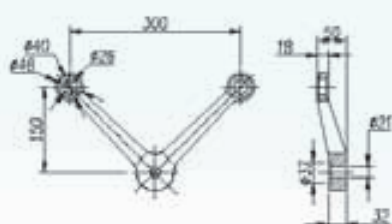

300A21

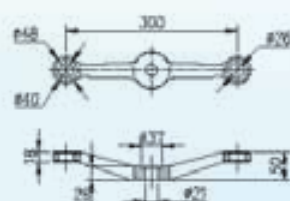

300A1

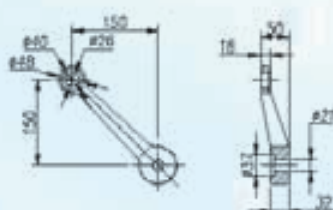

300A11

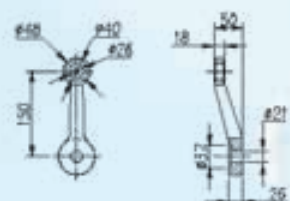

300B Series



300B4

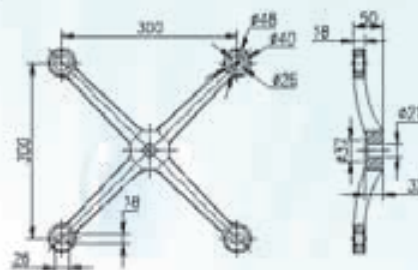

300B2

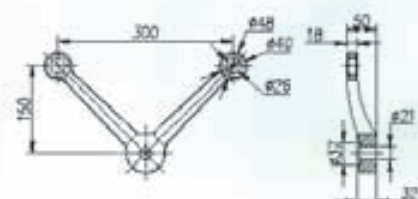

300B21

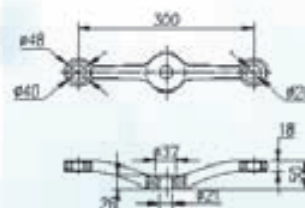

300B1

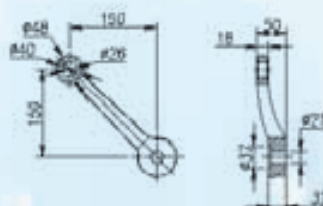

300B11

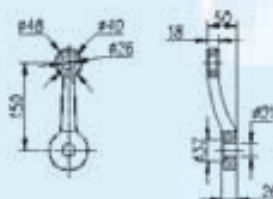

300C Series

300C4

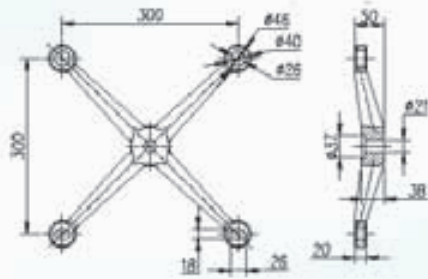

300C2

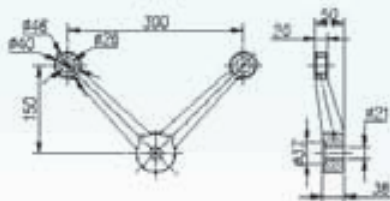

300C21

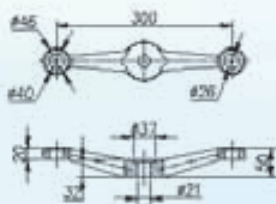

300C1

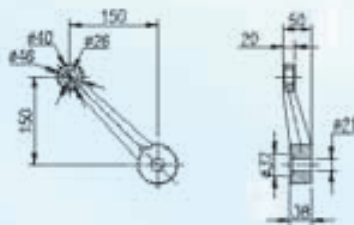

300C11

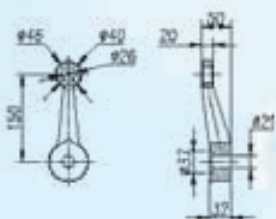

3040B Series



3040B4

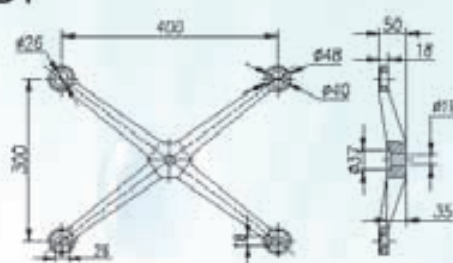

3040B2

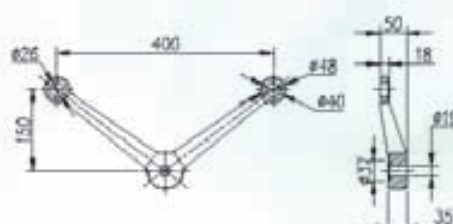

3040B21

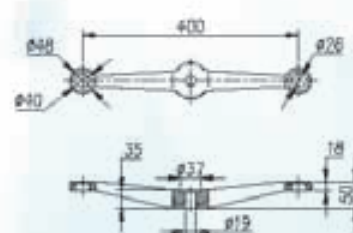

3040B1

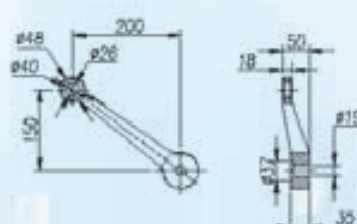

3040B11

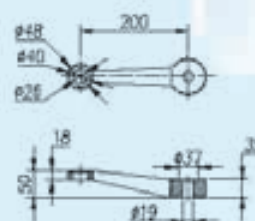

250HA Series

250HA4

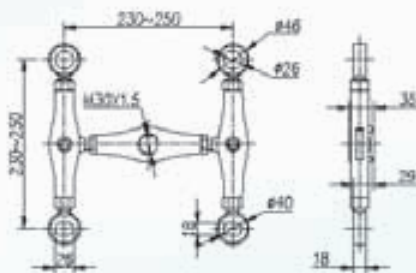

250HA21

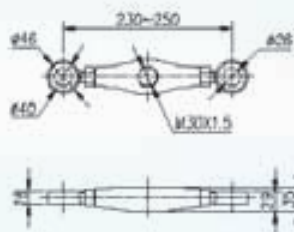

250HA25

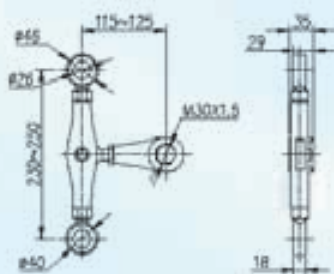

250HA11

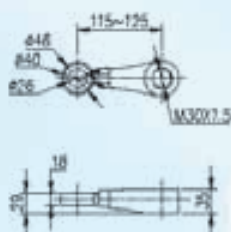

250HB Series



250HB4

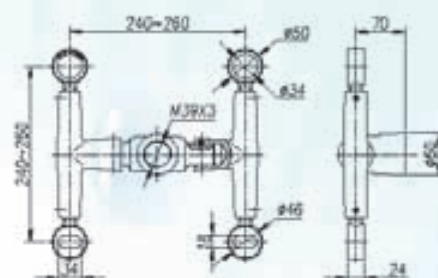

250HB21

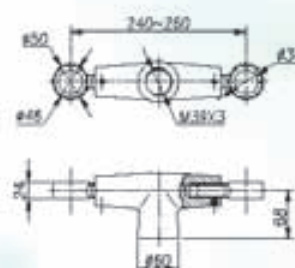

250HB25

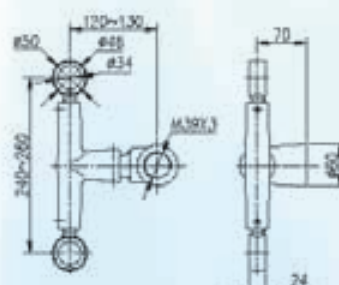

250HB11

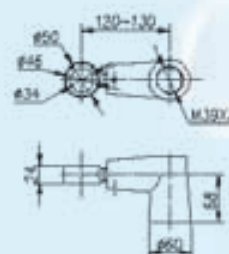

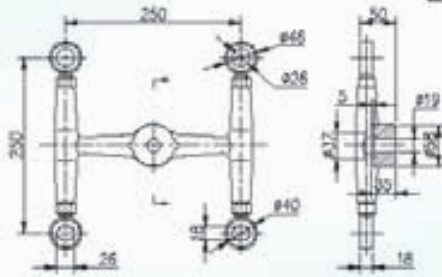
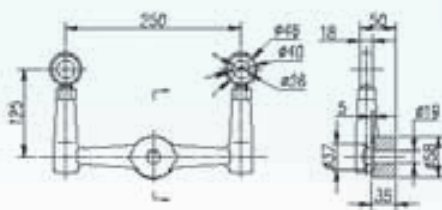
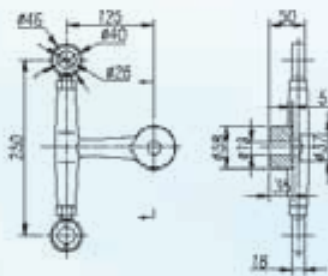
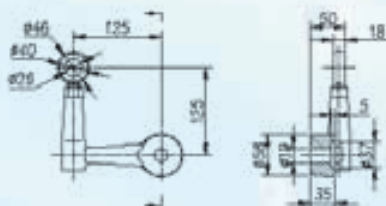
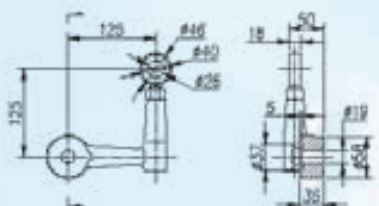
250HE Series**250HE4****250HE2****250HE25****250HE1****250HE12**

300HA Series



300HA4

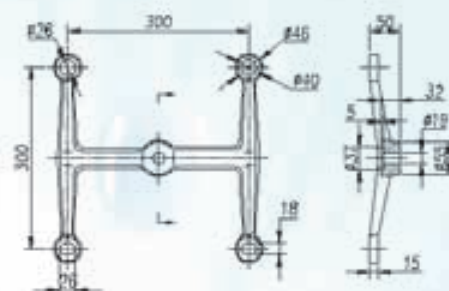

300A21

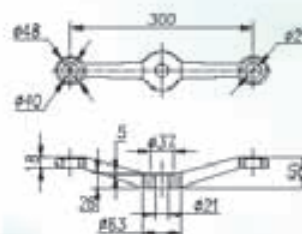

300HA25

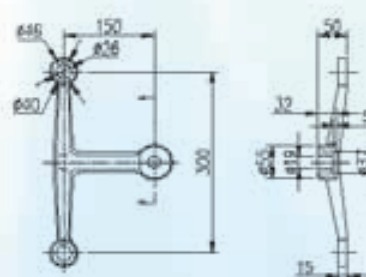

300A11

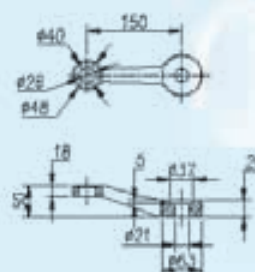

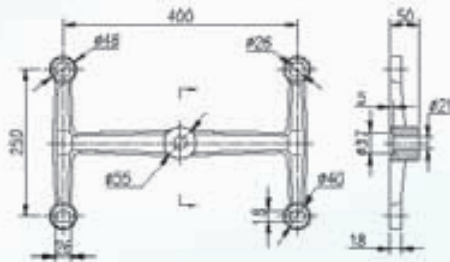
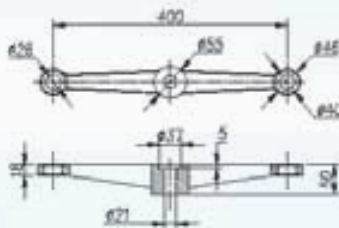
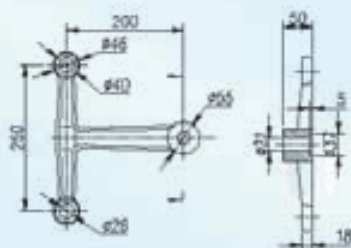
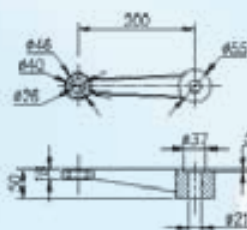
2540HA Series**2540HA4****2540HA21****2540HA25****2540HA11**

3060HA Series



3060HA4

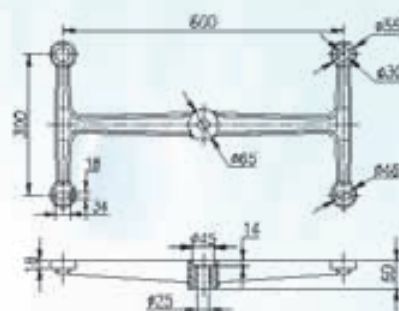

3060HA21

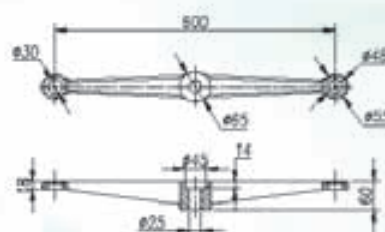

3060HA25

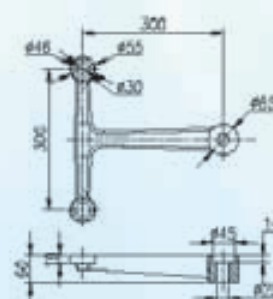

3060HA11

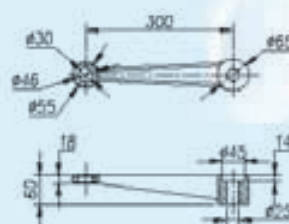

4080HA Series

4080HA4

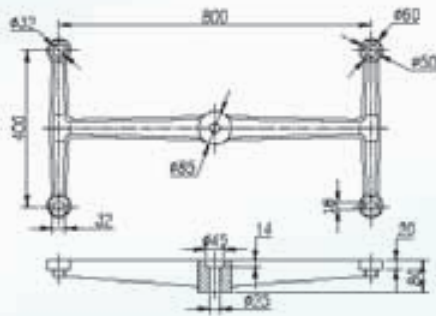

4080HA21

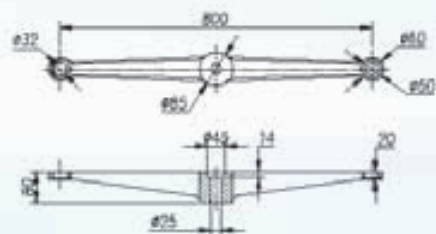

4080HA25

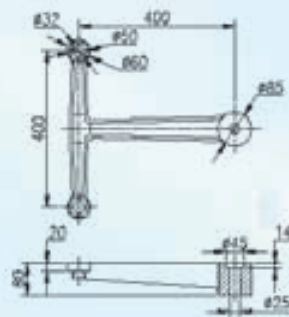

4080HA11

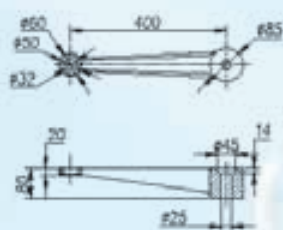

3060A Series



3060A4

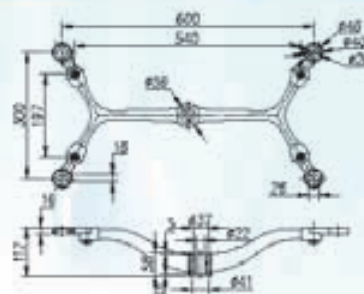

3060A2

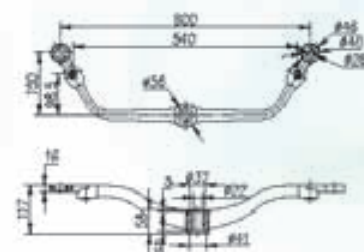

3060A25

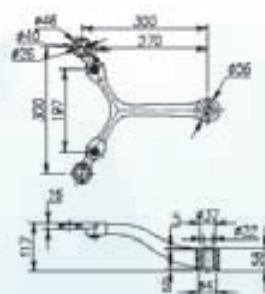

3060A1

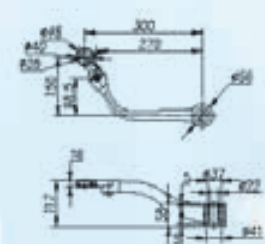

3060A12

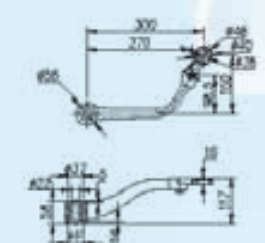

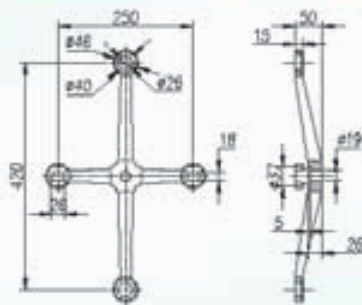
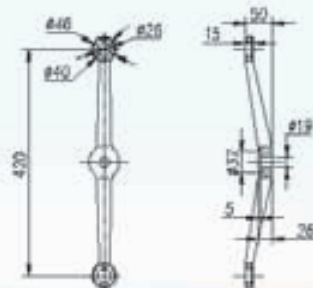
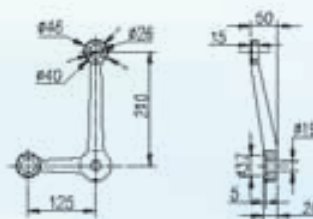
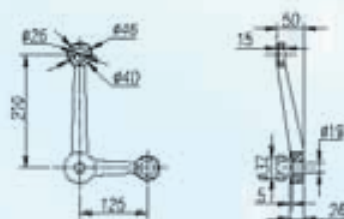
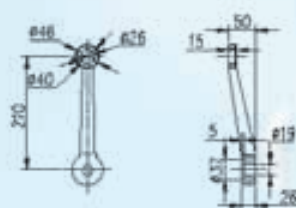
**2542TA Series****2542TA4****2542TA21****2542TA23****2542TA24****2542TA1**

3060TA Series



3060TA4

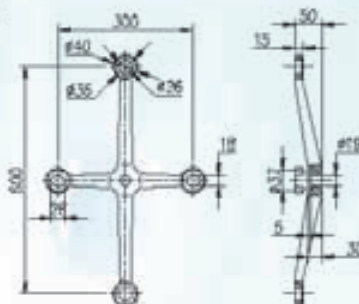

3060TA21

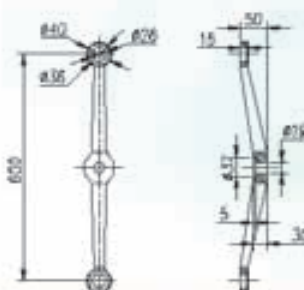

3060TA23

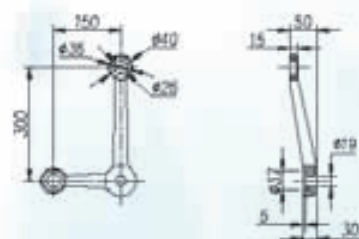

3060TA24

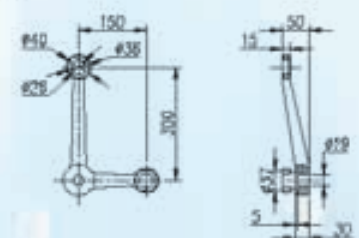

3060TA11

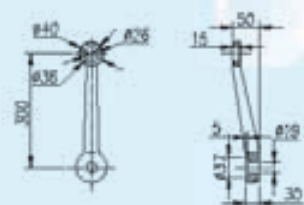

J3030T Series

J3030T4

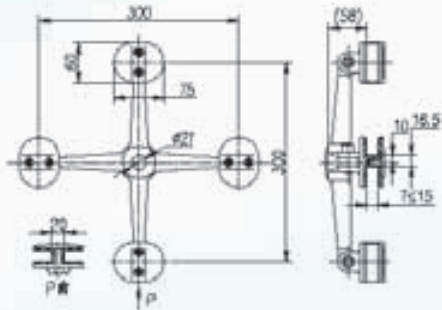

J3030T21

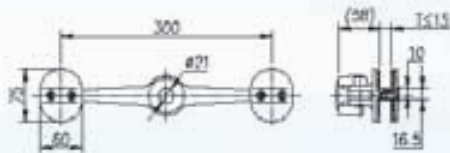

J3030T23

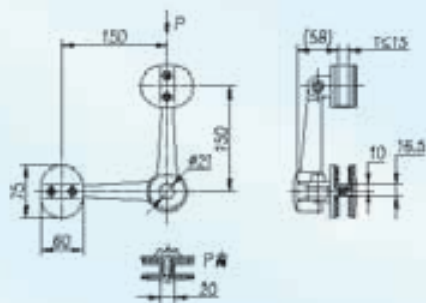

J3030T11

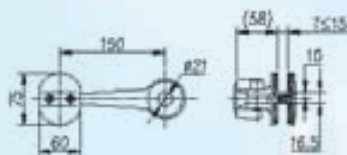

Adjustable Spider Assemble



4706K

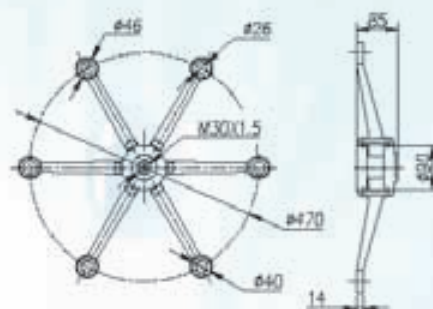

4706G

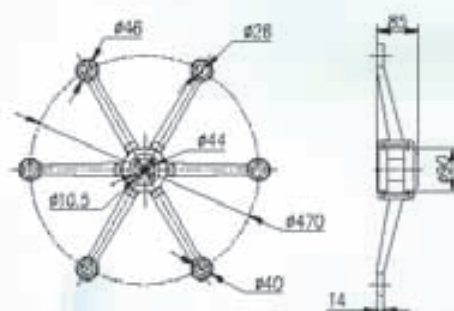

5006K

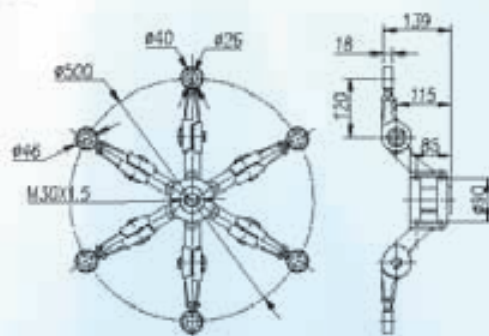

A5006K

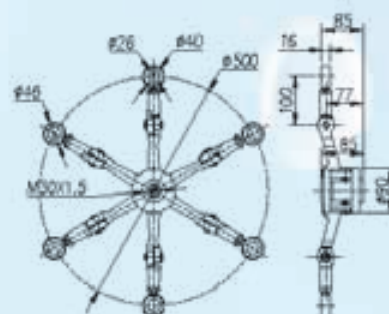

L210A Series

L210A4

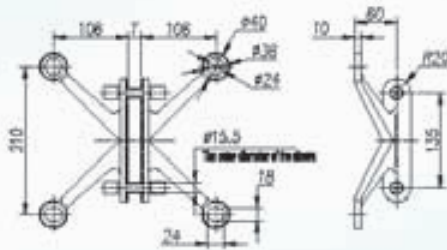

L210A1

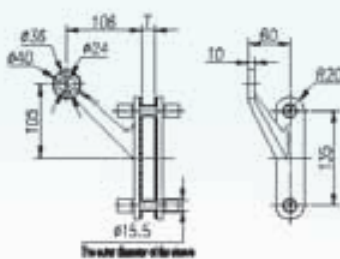

L210A12

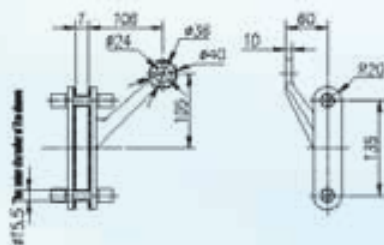

L210A2

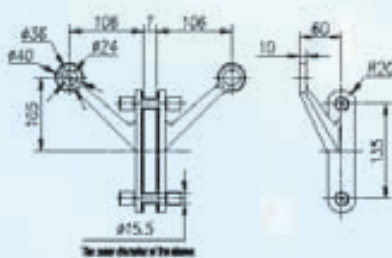

L210A25

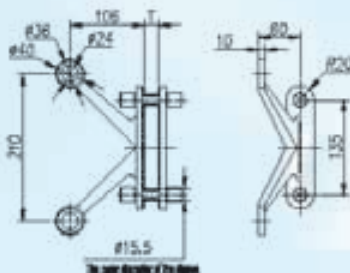

L220A Series



L220A4

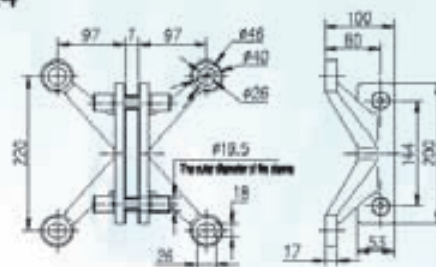

L220A1

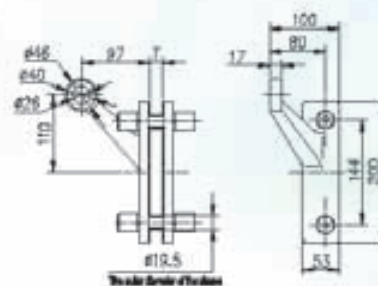

L220A12

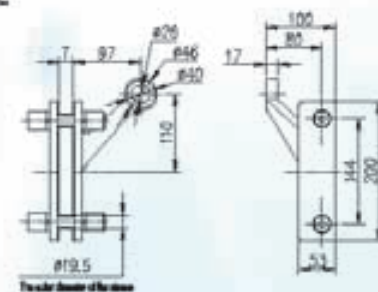

L220A2

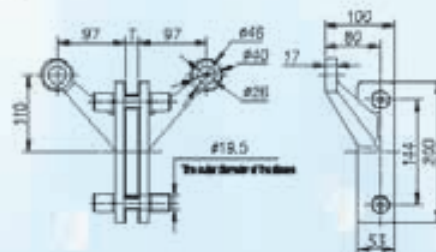

L220A25

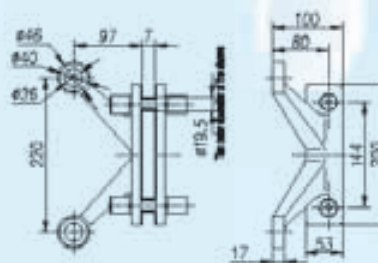

L220B Series

L220B4

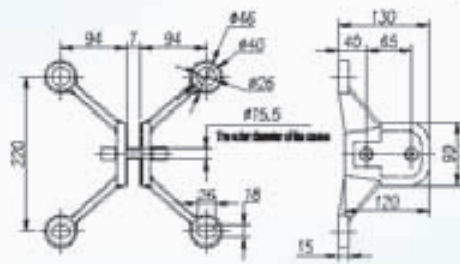

L220B1

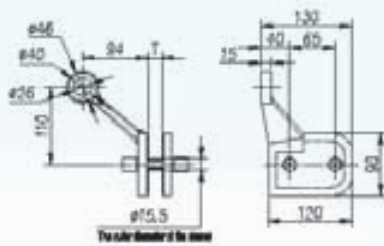

L220B12

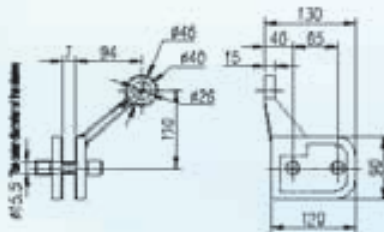

L220B2

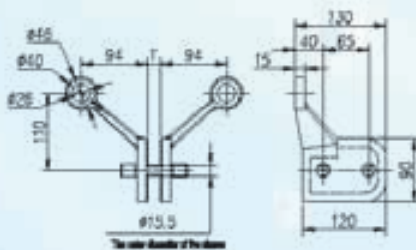

L220B25

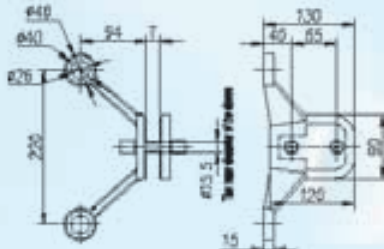

L220C Series



L220C4

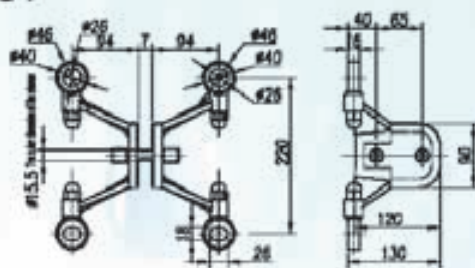

L220C1

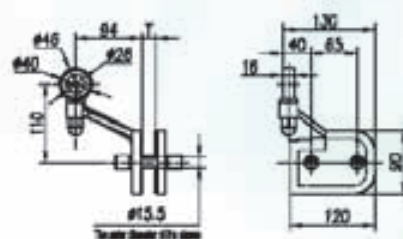

L220C12

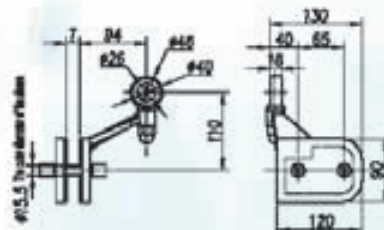

L220C2

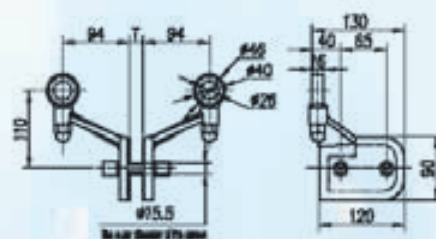

L220C25

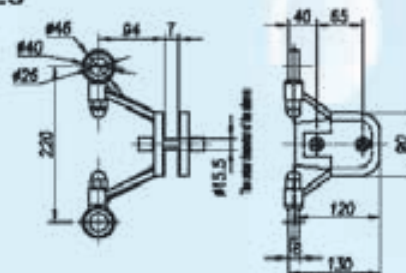

L220D Series

L220D4

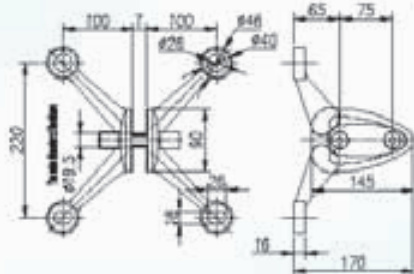

L220D1

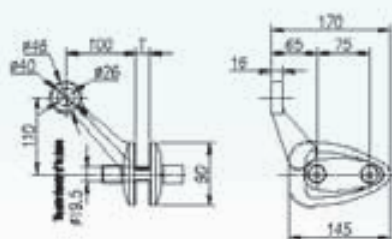

L220D12

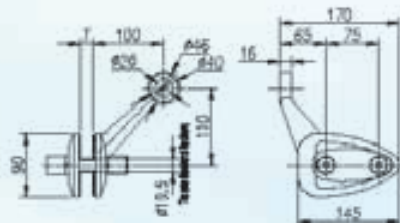

L220D2

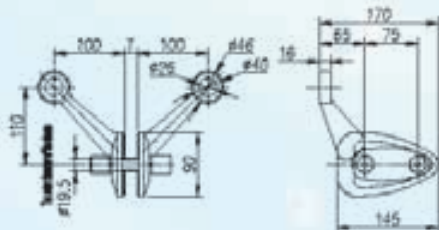

L220D25

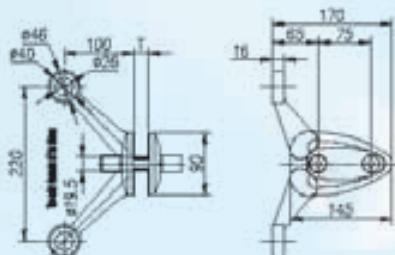

L250A Series



L250A4

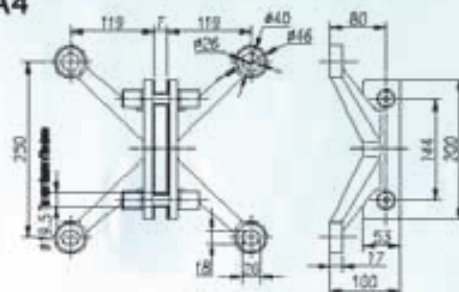

L250A1

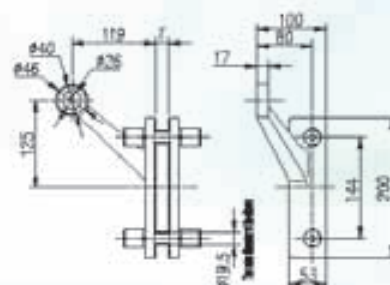

L250A12

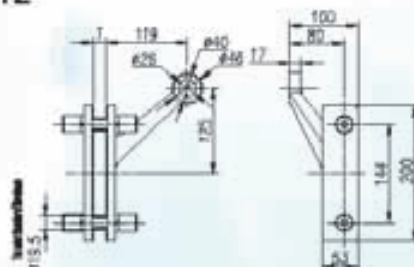

L250A2

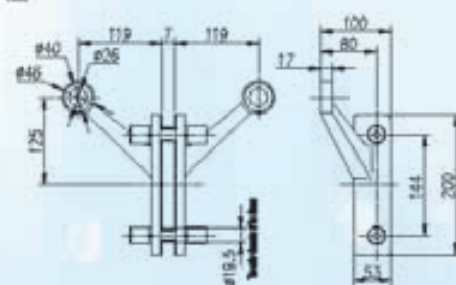

L250A25

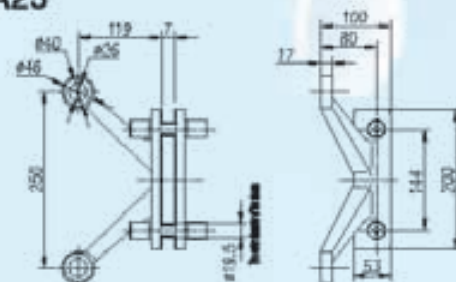

L250B Series

L250B4

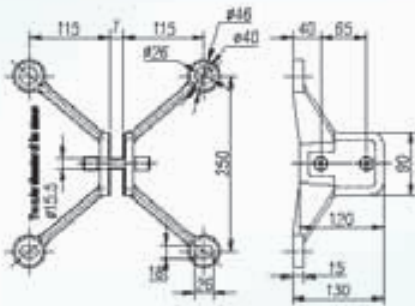

L250B1

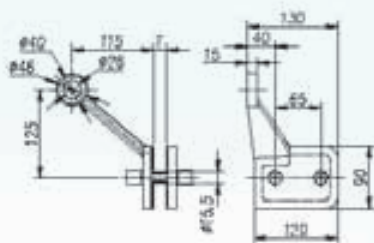

L250B12

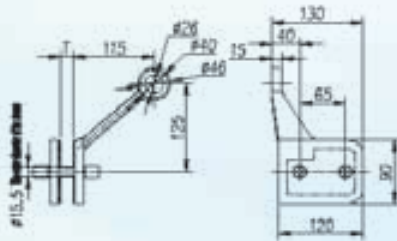

L250B2

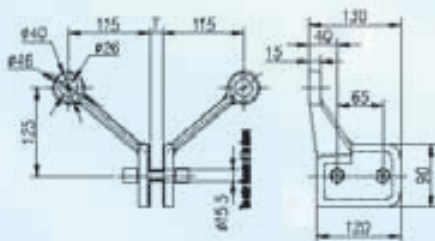

L250B25

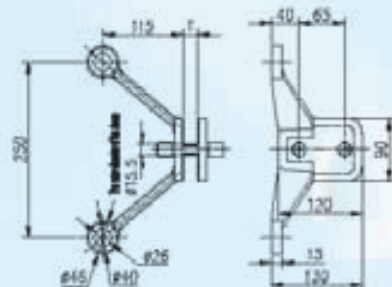

L250C Series



L250C4

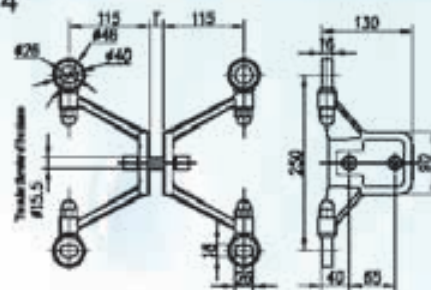

L250C1

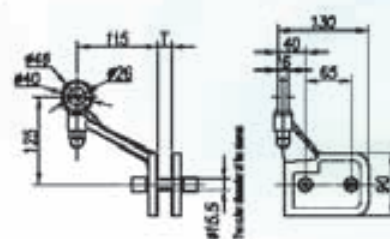

L250C12

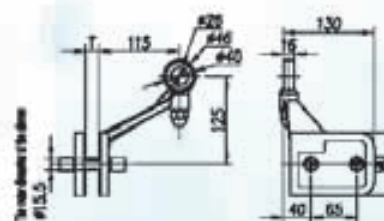

L250C2

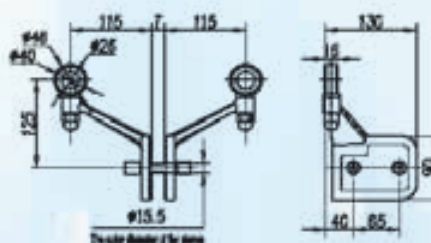

L250C25

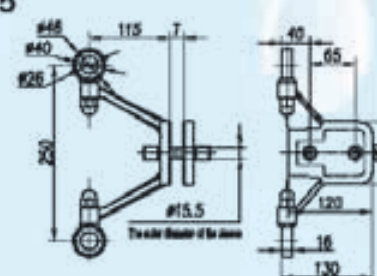

L250D Series

L250D4

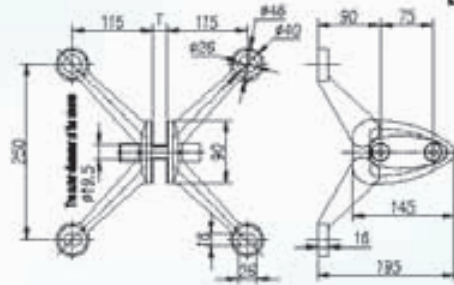

L250D1

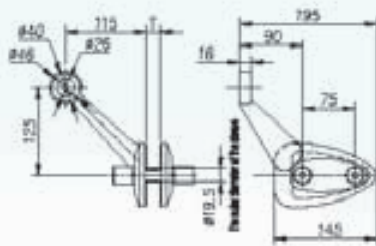

L250D12

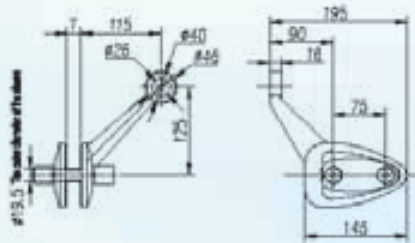

L250D2

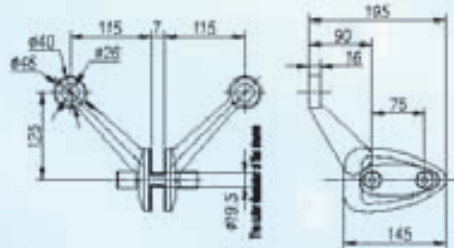

L250D25

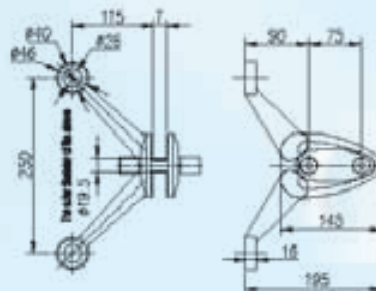

L250E Series



L250E4

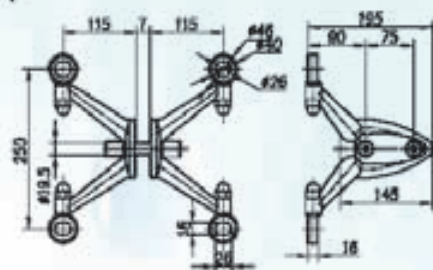

L250E1

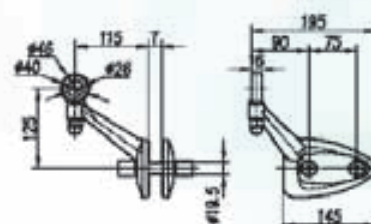

L250E12

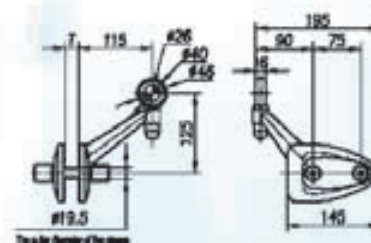

L250E2

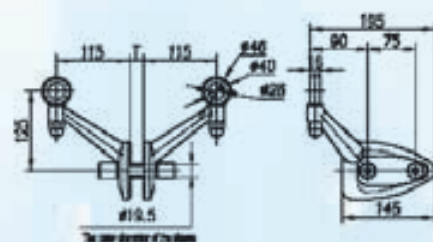

L250E25

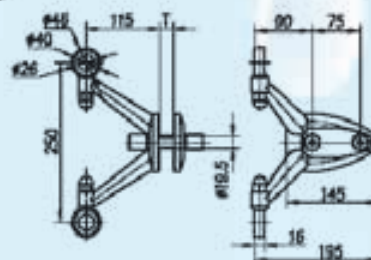

L250F Series

L250F4

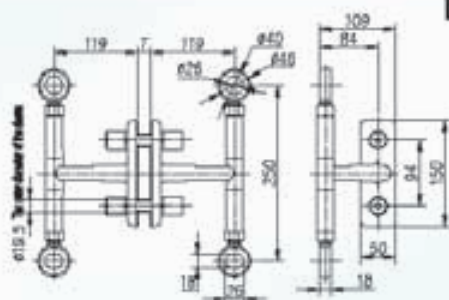

L250F1

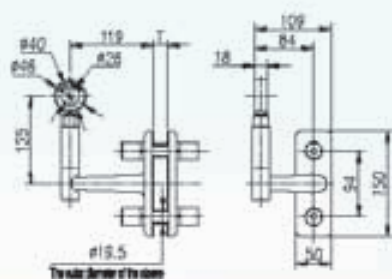

L250F12

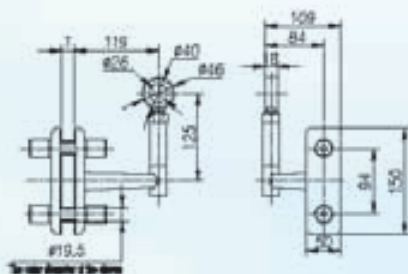

L250F2

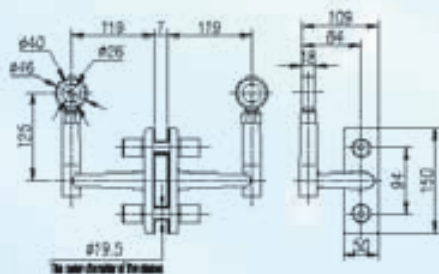

L250F25

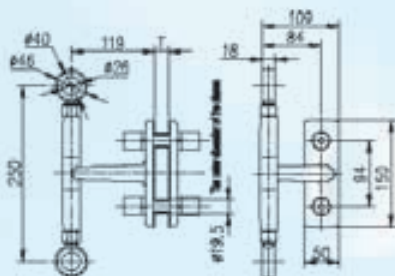

L250G Series



L250G4

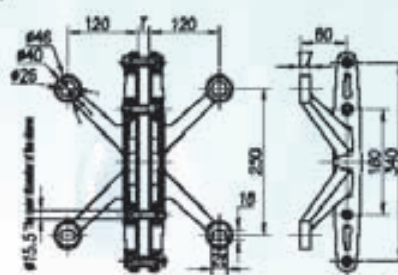

L250G1

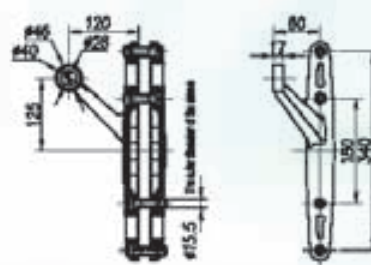

L250G12

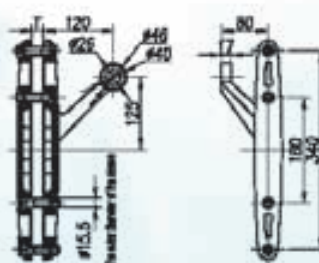

L250G2

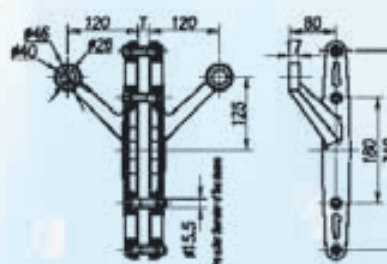

L250G25

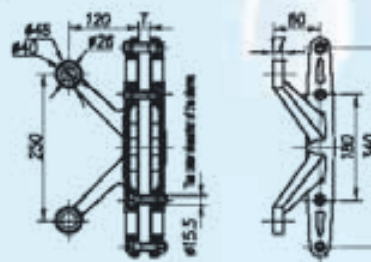



L240 Series



L240B

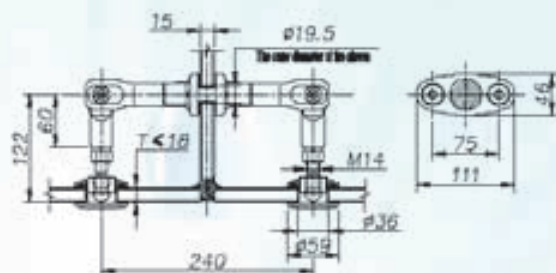

L240D

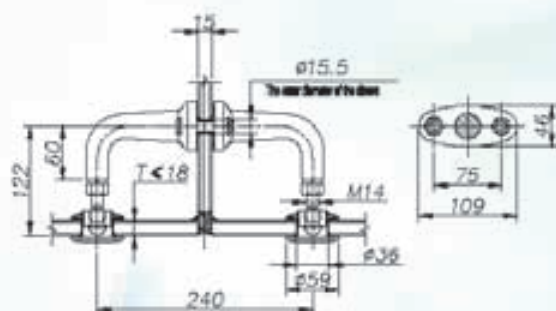

L300CY

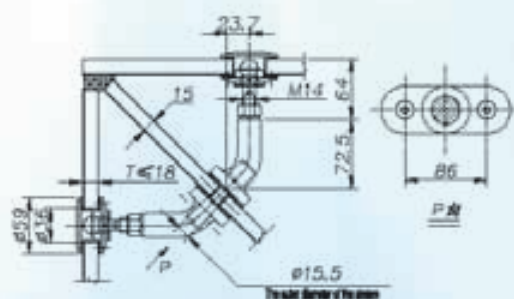

L300CN

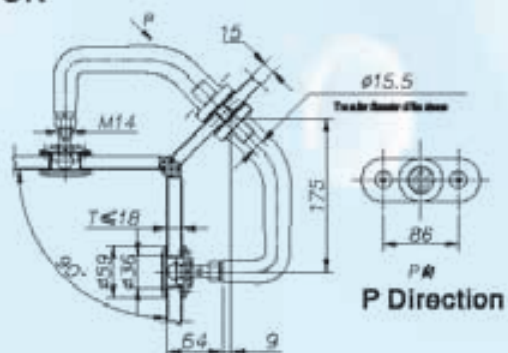

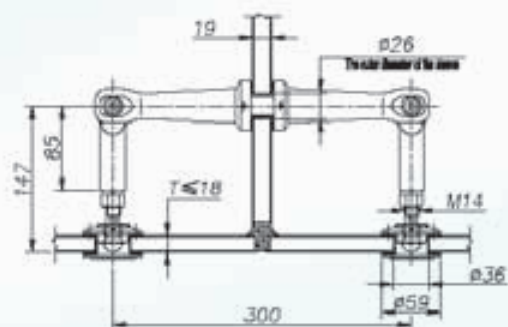
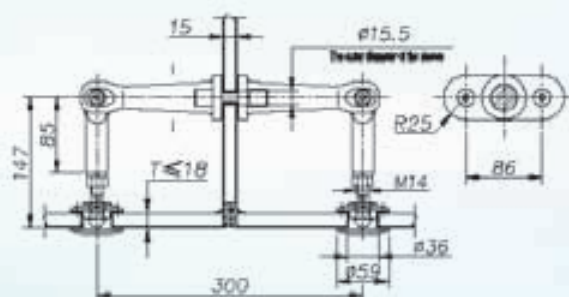
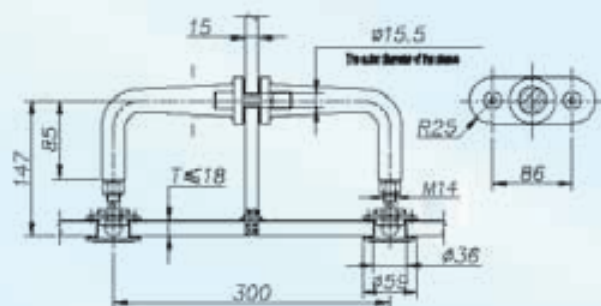
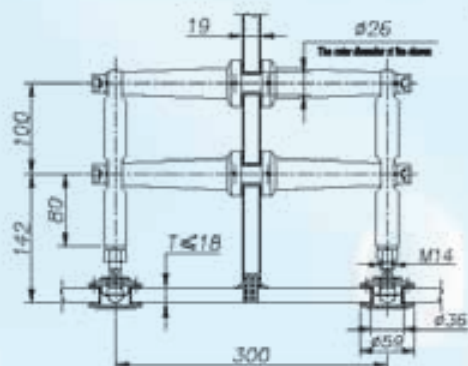
**L300 Series****L300A****L300B****L300C****L300D**

L300 Series



L300E

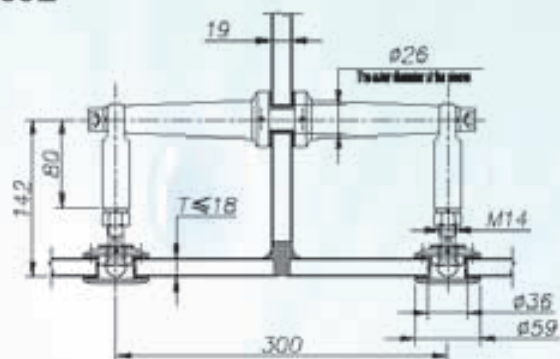

L300F

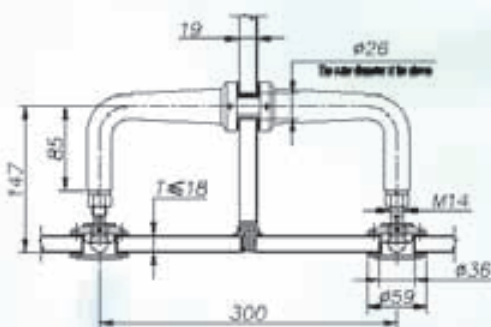

L300FY

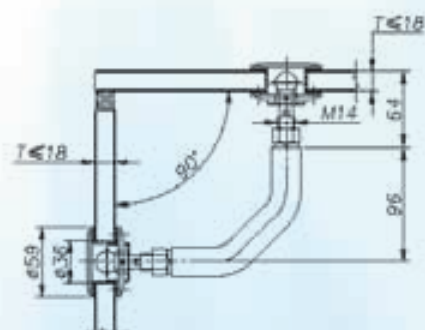

L300G

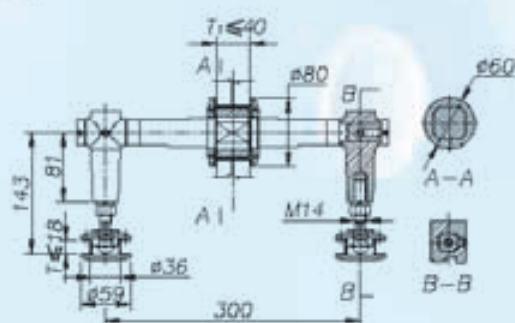

Kinds of wrenches



Statement

1. We compiled this brochure carefully, and based on familiarity and understanding to our products at this stage, we think the information in this brochure is correct and workable, but if any dissidence exist in this brochure, welcome to contact us.

2. Please kindly be informed that some information in this version is different from those in the previous versions, and we propose that the product selection should be based on the latest version of KinLong brochures. If the product model in the previous versions is needed, please contact the local KinLong office to get the latest information of our production and sales.

3. After issuing the current brochure version, KinLong will go on improving some of the products without prior notification. If the product performance can't fulfill your requirement or you have some query about our products, please contact the local KinLong office or visit KinLong website to get the latest product information.

4. The design & information on this brochure has been covered by the copyright protection and the printing & copy will be forbidden without KinLong authorized documents.



Point-fixed Glass Wall Fitting



S.S Tension Cable&Tension Rod



Cast-in Channel Accessory

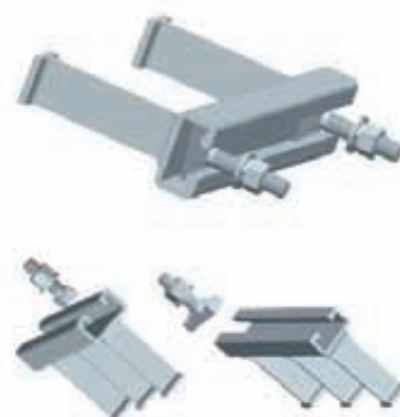

S.S Post Railing System



Aluminum Door&Window Accessory



U Groove Door&Window Accessory





坚朗 KIN LONG PRODUCT WORLD

CONSTRUCTION HARDWARE EXPERT

Frction Stay and Pegstay Series



Sliding Roller Series



Door Control Hardware Fitting



Mechanical lock Series



Smart Door Lock



Bathroom Hardware Accessory





ISO 9001:2008 / FM 18418
BS EN ISO 14001:2004 / EMS 90480
BS OHSAS 18001:2007 / OHS 063601

GUANGDONG KIN LONG HARDWARE PRODUCTS CO.,LTD

ADD: Daping Industrial Zone, Tangxia Town,

DongGuan City, GuangDong Province, China

Tel: +86-769-82166666 82136666 +86-13827420353

Fax: +86-769-82955269 82955268

E-mail: mail@kinlong.com



All rights reserved
Print on Jan,2014